

# SANITARY SEWER SERVICE LOCATION

Town, City of: CUMBERLAND

Date Installed JUNE 22, 1983

Street LONG MEADOW RD

Type, Size of Service Pipe 6" PVC

Dwelling No. 31

Connection at Sewer Main WYE, MH 11+29 + 2'

Occupant Doris

Depth, End of Service Pipe 6' DEEP @ SLOPE = 1" / FOOT

Owner \_\_\_\_\_

Length of Service Pipe Laid 33.5' of 6" PVC

Measured, Located By \_\_\_\_\_

Project Contractor S.E. MACMILLAN

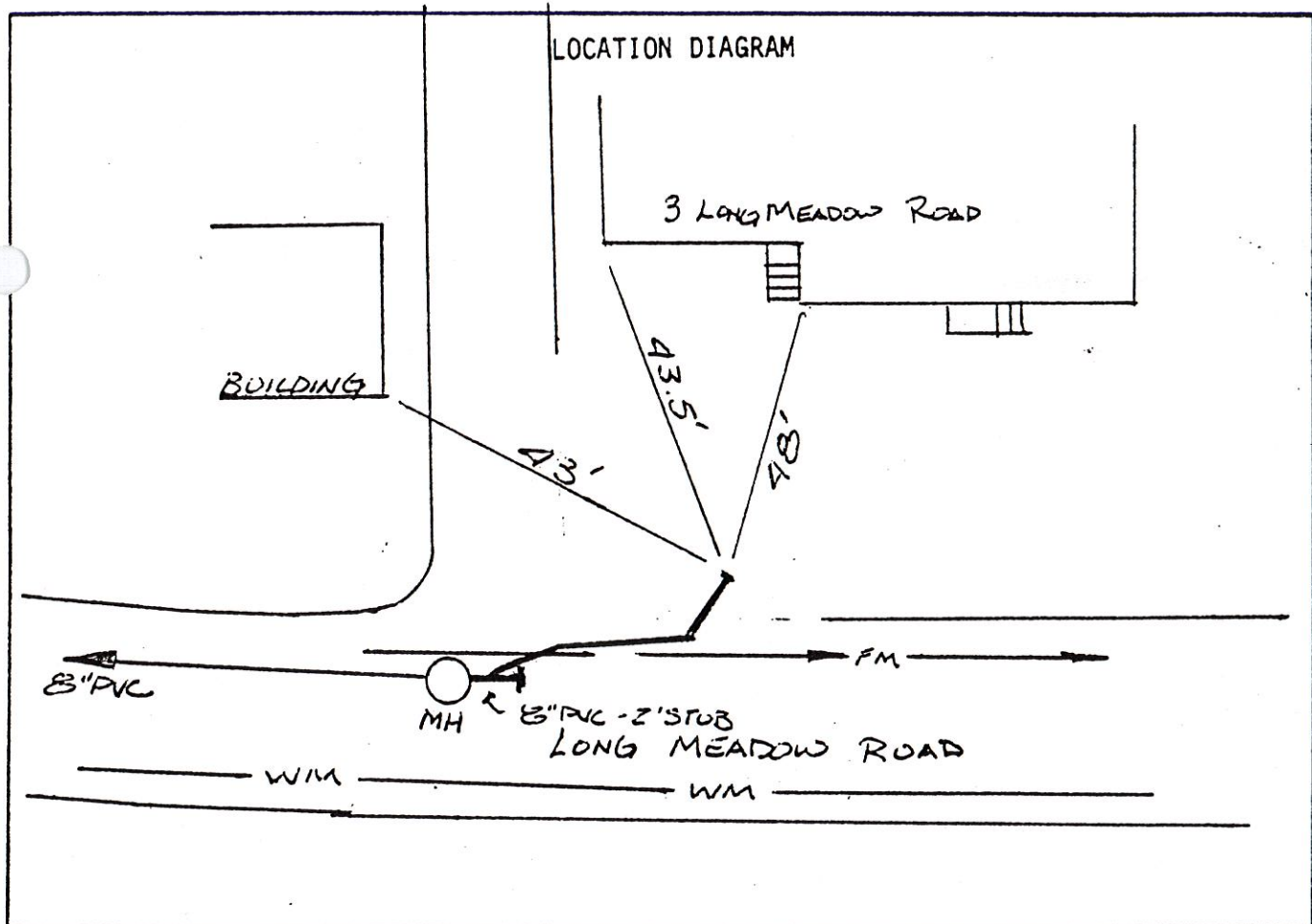

Remarks: 6" PVC GOES OVER 6" FORCE MAIN BY 6"

\_\_\_\_\_

\_\_\_\_\_

\_\_\_\_\_

\_\_\_\_\_

\_\_\_\_\_

# SANITARY SEWER SERVICE LOCATION

Town, City of: Cumberland Me.

Date Installed 5/19/83

Street Long Meadow Rd

Type, Size of Service Pipe 6" PVC

Dwelling No. 7

Connection at Sewer Main "T" @ 4m#13 + 182.5'

Occupant \_\_\_\_\_

Depth, End of Service Pipe 5.

Owner \_\_\_\_\_

Length of Service Pipe Laid 12'

Measured, Located By AHB

Project Contractor \_\_\_\_\_

## LOCATION DIAGRAM

LONG MEADOW RD

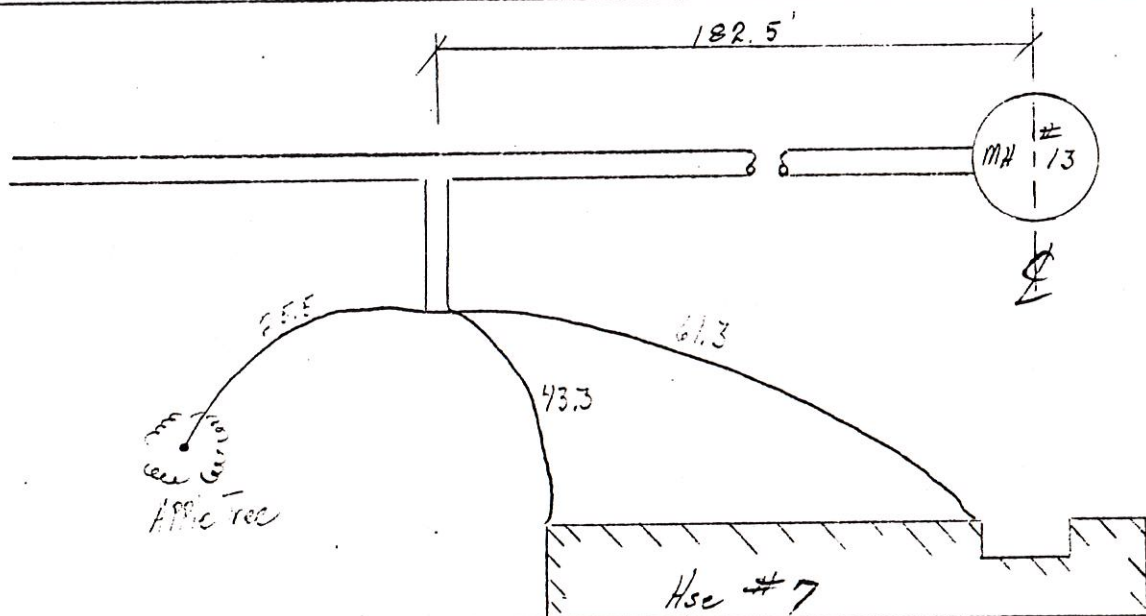

Remarks:

# SANITARY SEWER SERVICE LOCATION

Town, City of: Cumberland Me.

Date Installed 5/19/83

Street Long Meadow Rd

Type, Size of Service Pipe 6" PVC

Dwelling No. 7

Connection at Sewer Main T @ #13 + 182.5'

Occupant \_\_\_\_\_

Depth, End of Service Pipe 5'

Owner EVERETT CARLSON

Length of Service Pipe Laid 12'

C-1-C592

Measured, Located By AHB

Project Contractor \_\_\_\_\_

## LOCATION DIAGRAM

LONG MEADOW RD

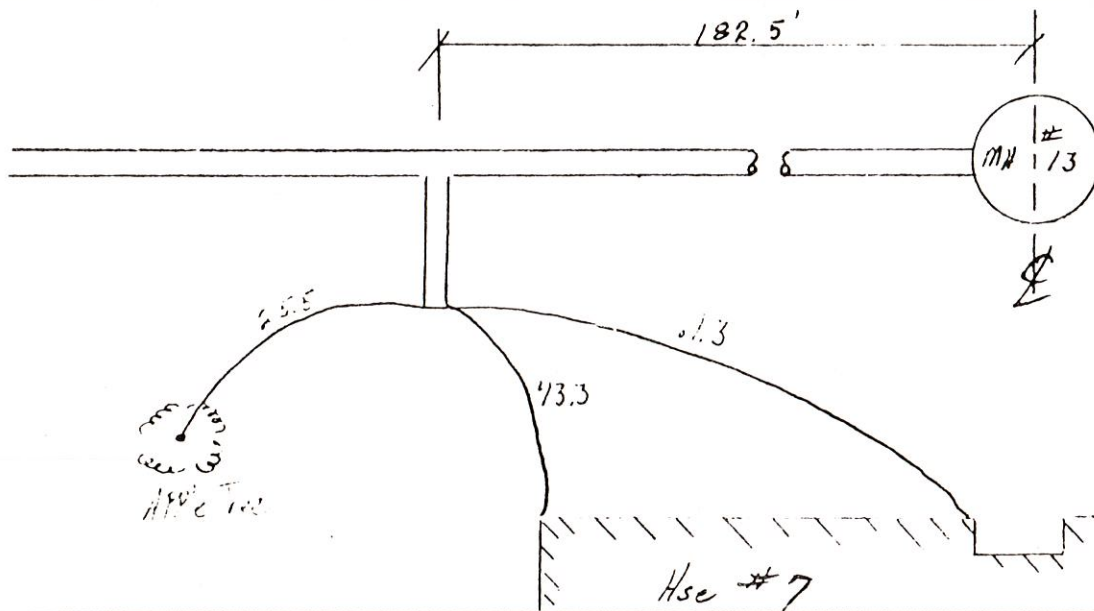

Remarks:



# SAMPLE BUILDING SEWER SKETCH

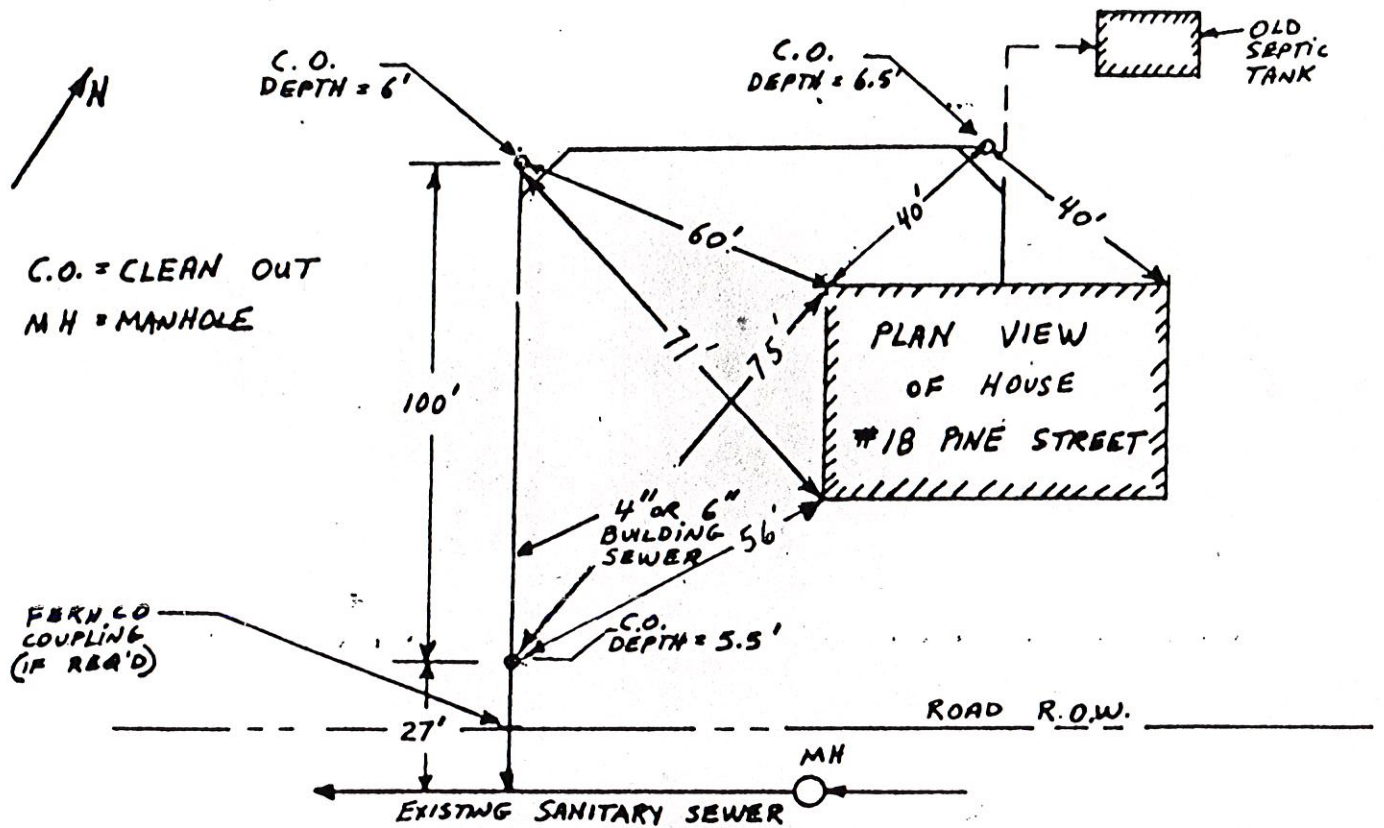

NAME: Everett Carlson  
 ADDRESS: 7 Longmeadow Rd  
 CONTRACTOR: Richard P. Waetz

DATE: July 9-1984  
 COLLECTOR OR INTERCEPT

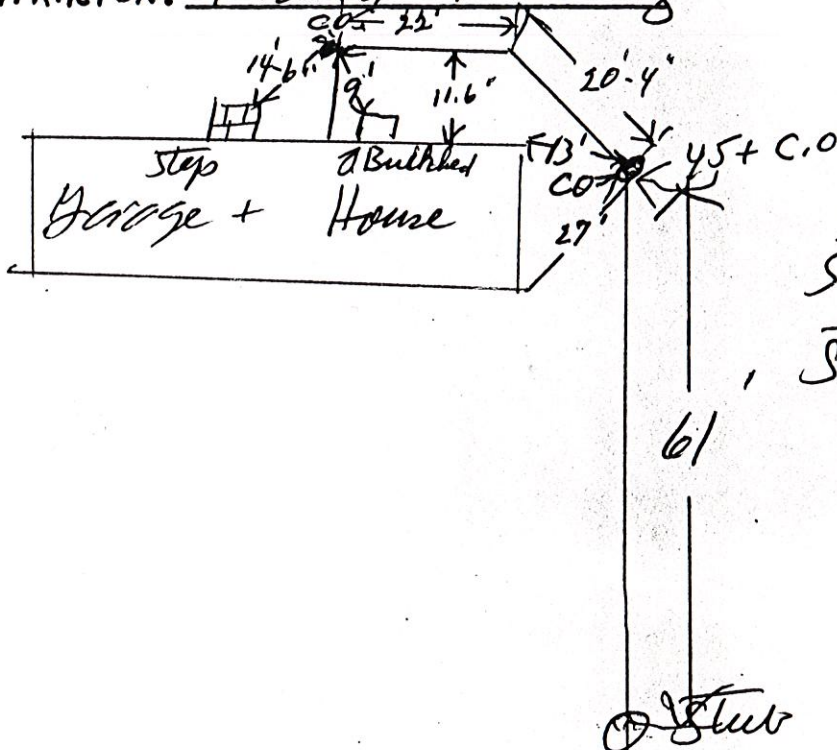

2 - Cleanouts  
 Sched 40 P.V.C.  
 Stub 5 ft Deep.

PT  
 88

Longmeadow



# SANITARY SEWER SERVICE LOCATION

Town, City of: CUMBERLAND

Date Installed JUNE 21, 1983

Street LONG MEADOW RD

Type, Size of Service Pipe 6" PVC

Dwelling No. 8

Connection at Sewer Main WYE, MH 3+20+23

Occupant \_\_\_\_\_

Depth, End of Service Pipe 11' DEEP

Owner John Alberti

Length of Service Pipe Laid 29.5'

C-1-C629

Measured, Located By \_\_\_\_\_

\_\_\_\_\_

Project Contractor S.E. MACMILLAN

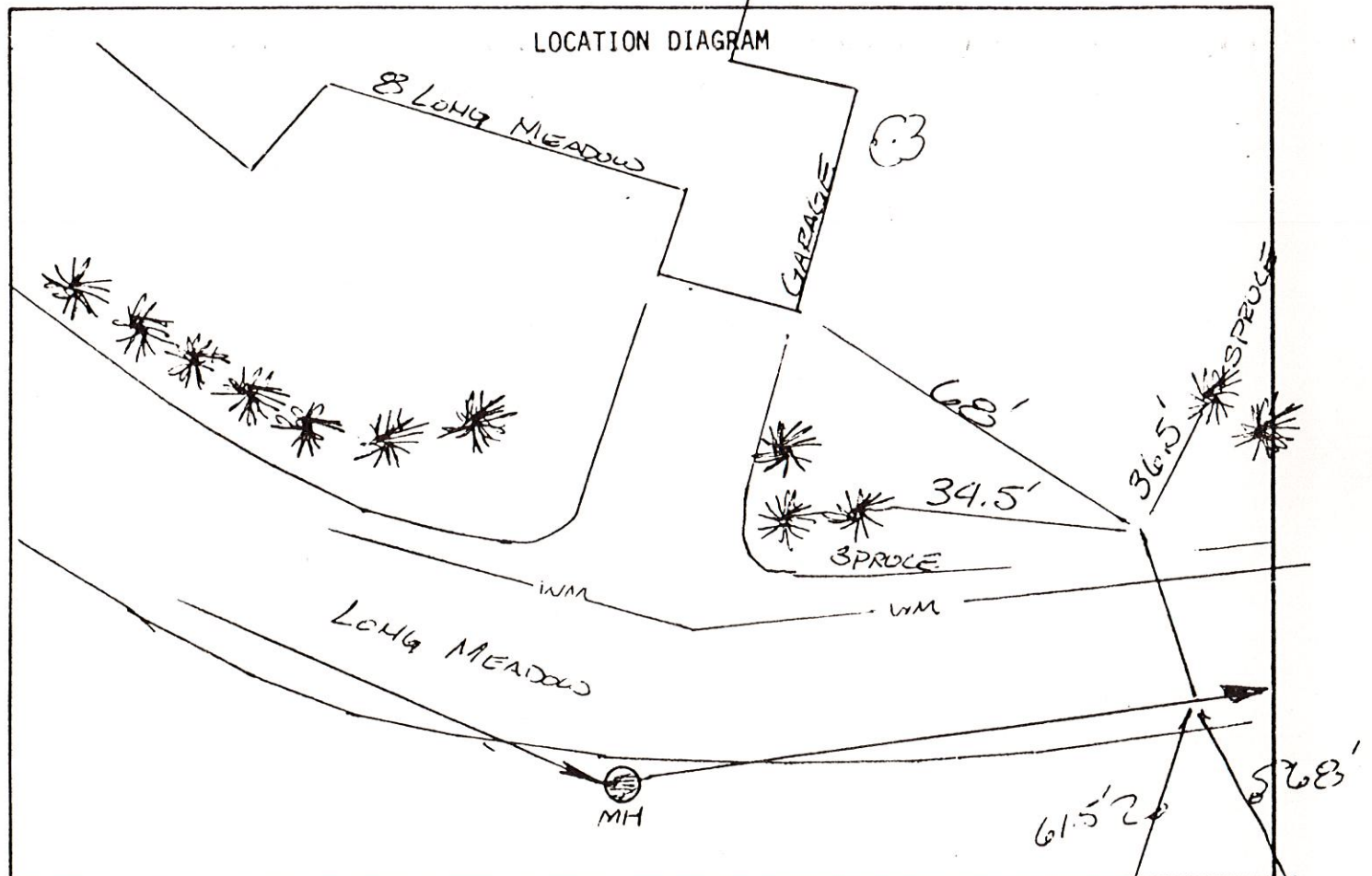

Remarks: PLUMBING FROM HOUSE UNDER FOUNDATION SLAB

#11

# SANITARY SEWER SERVICE LOCATION

Town, City of: COMBERLAND

Date Installed JUNE 21, 1983

Street LONG MEADOW RD

Type, Size of Service Pipe 6" PVC

Dwelling No. 8

Connection at Sewer Main WYE, MH 3+20+233

Occupant \_\_\_\_\_

Depth, End of Service Pipe 11' DEEP

Owner \_\_\_\_\_

Length of Service Pipe Laid 29.5'

Measured, Located By \_\_\_\_\_

Project Contractor S.E. MACMILLAN

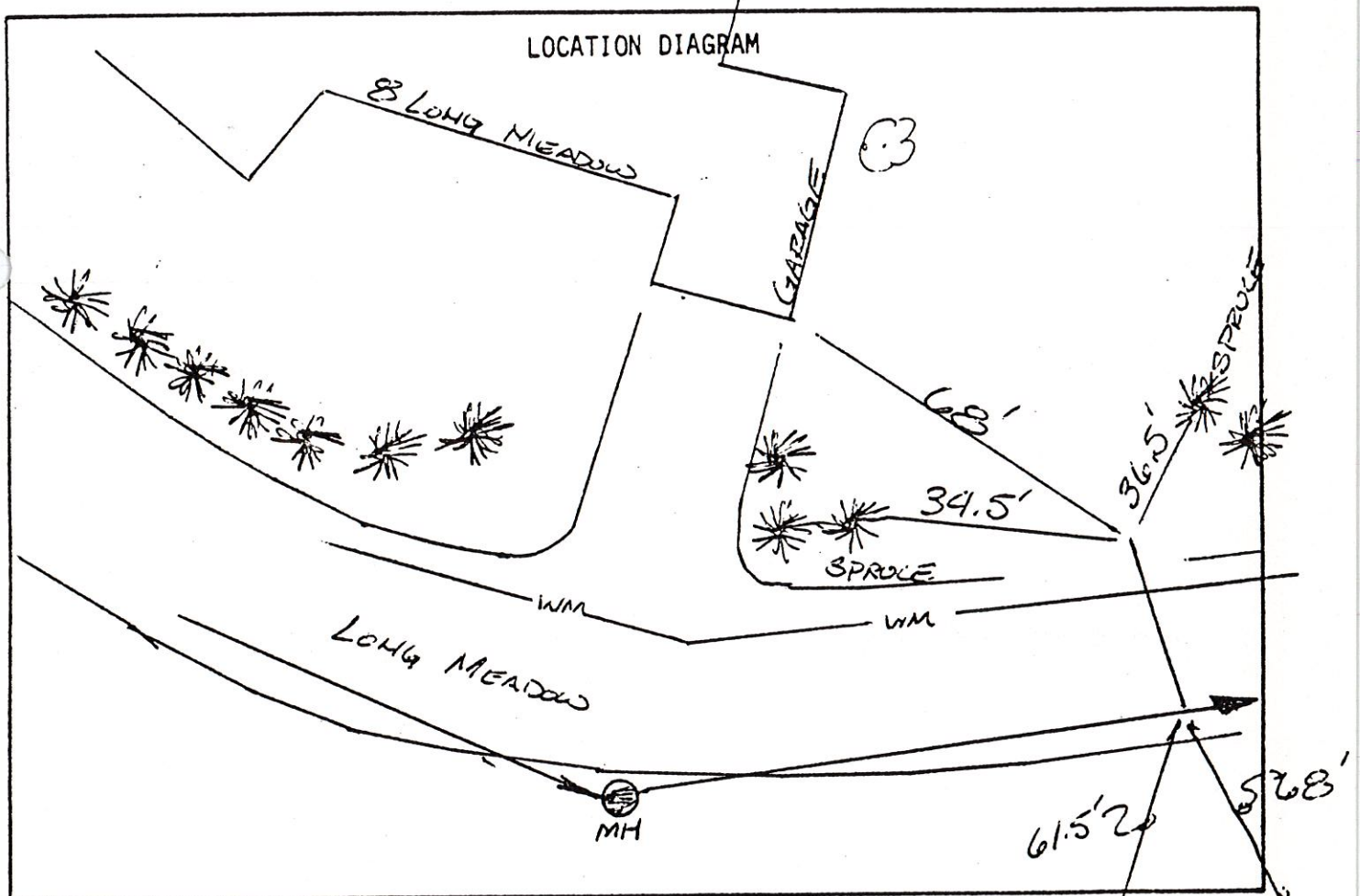

Remarks: PLUMBING FROM HOUSE UNDER FOUNDATION SLABS

# SANITARY SEWER SERVICE LOCATION

Town, City of: Cumberland

Date Installed \_\_\_\_\_

Street Longmeadow

Type, Size of Service Pipe 6" PVC

Dwelling No. 8

Connection at Sewer Main WYE

Occupant \_\_\_\_\_

Depth, End of Service Pipe \_\_\_\_\_

Owner \_\_\_\_\_

Length of Service Pipe Laid \_\_\_\_\_

Measured, Located By \_\_\_\_\_

Project Contractor S.E. MacMillan

## LOCATION DIAGRAM

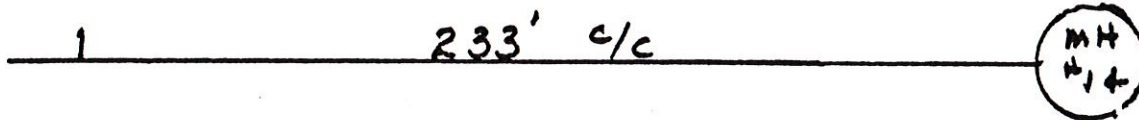

Remarks:

\_\_\_\_\_  
 \_\_\_\_\_  
 \_\_\_\_\_  
 \_\_\_\_\_  
 \_\_\_\_\_



# SANITARY SEWER SERVICE LOCATION

Town, City of: Cumberland

Date Installed 5-18-83

Street Longmeadow

Type, Size of Service Pipe 6" PVC

Dwelling No. #9

Connection at Sewer Main WYE

Occupant \_\_\_\_\_

Depth, End of Service Pipe 5.5'

Owner \_\_\_\_\_

Length of Service Pipe Laid 15.5'

Measured, Located By \_\_\_\_\_

Project Contractor S.E. MacMillan

## LOCATION DIAGRAM

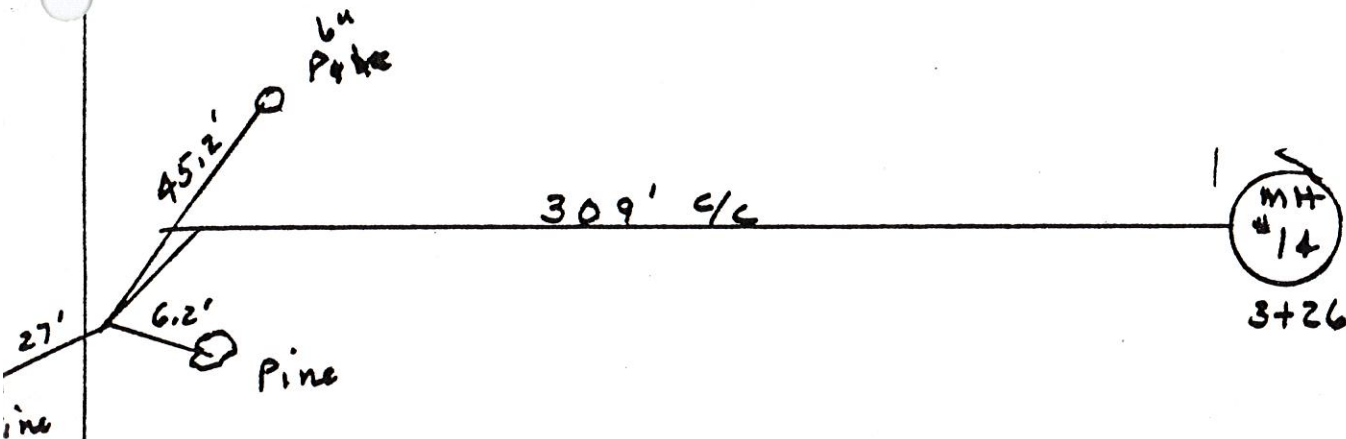

Remarks:

\_\_\_\_\_  
 \_\_\_\_\_  
 \_\_\_\_\_  
 \_\_\_\_\_  
 \_\_\_\_\_

### SANITARY SEWER SERVICE LOCATION

Town, City of: CUMBERLAND

Date Installed JUNE 22, 1983

Street LONG MEADOW RD

Type, Size of Service Pipe 6" PVC

Dwelling No. 10

Connection at Sewer Main TEE, MH 3+26+55'

Occupant

Depth, End of Service Pipe 4' DEEP @ 1/4" FOOT

Owner

Length of Service Pipe Laid 27'

Measured, Located By

Project Contractor S.E. MACMILLAN

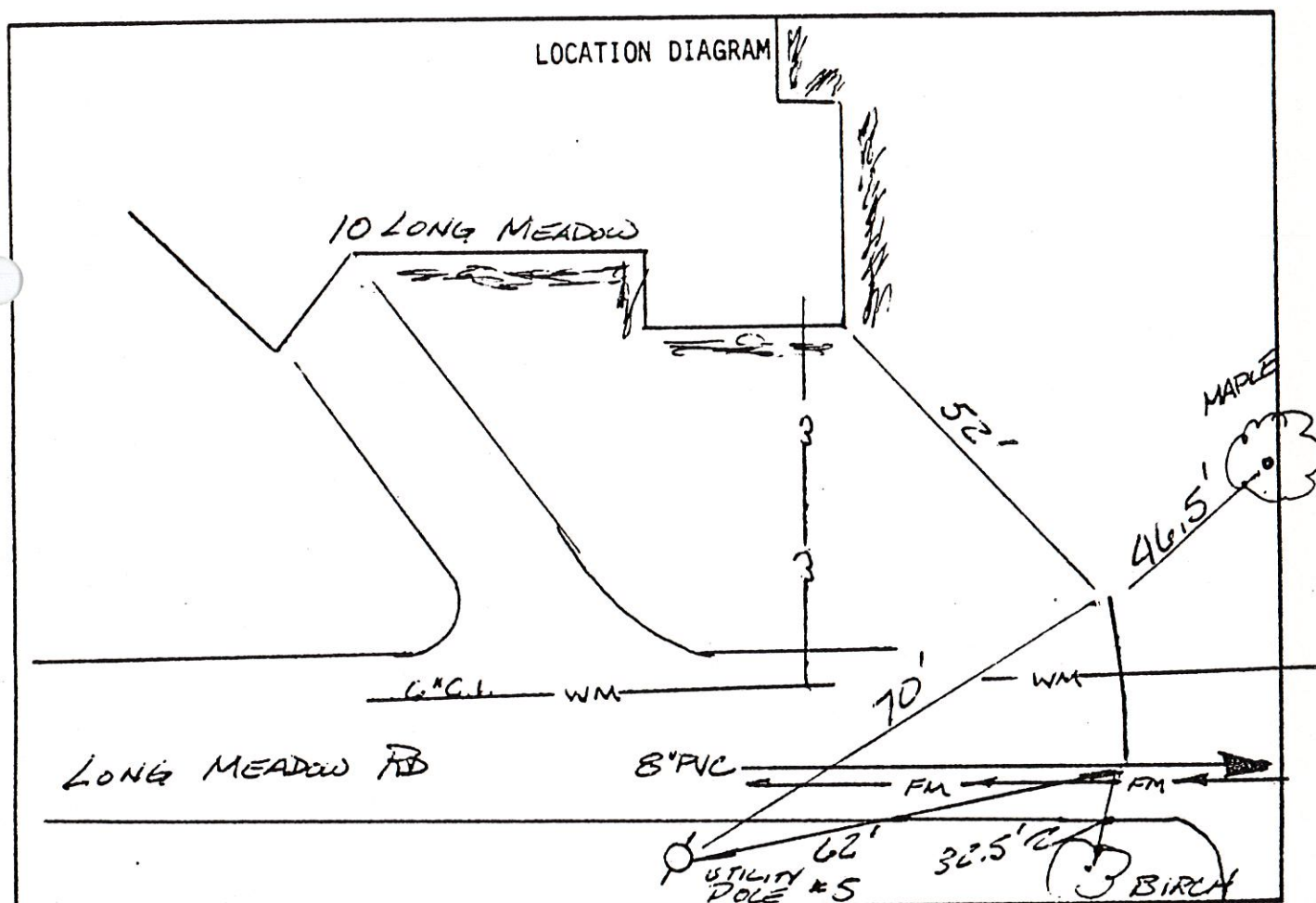

Remarks: 6" PVC OVER 6" WATER MAIN BY 1"

# SANITARY SEWER SERVICE LOCATION

Town, City of: Cumberland

Date Installed \_\_\_\_\_

Street Longmeadow Rd

Type, Size of Service Pipe 6" PVC

Dwelling No. #10

Connection at Sewer Main TEE

Occupant \_\_\_\_\_

Depth, End of Service Pipe \_\_\_\_\_

Owner \_\_\_\_\_

Length of Service Pipe Laid \_\_\_\_\_

Measured, Located By \_\_\_\_\_

Project Contractor \_\_\_\_\_

## LOCATION DIAGRAM

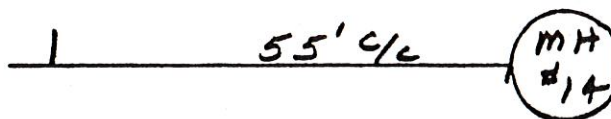

Remarks:

\_\_\_\_\_  
 \_\_\_\_\_  
 \_\_\_\_\_  
 \_\_\_\_\_  
 \_\_\_\_\_



DATE: July 5 1984  
COLLECTOR OR INTERCEPTOR

4  
Henry M. Brown

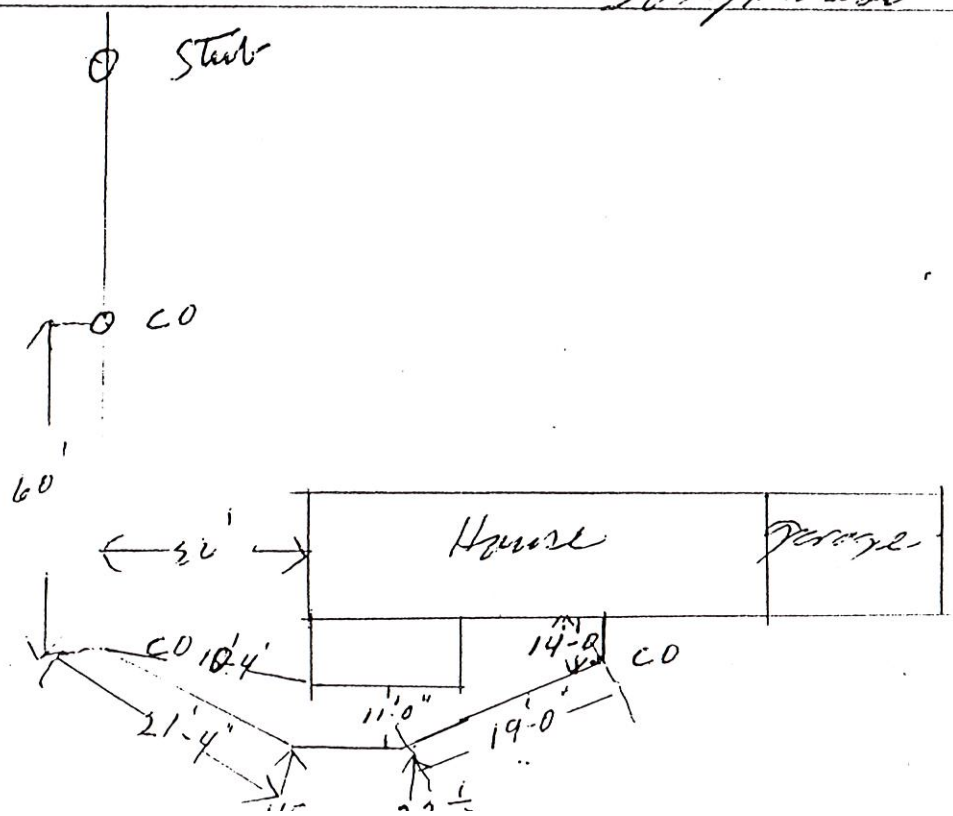

# SAMPLE BUILDING SEWER SKETCH

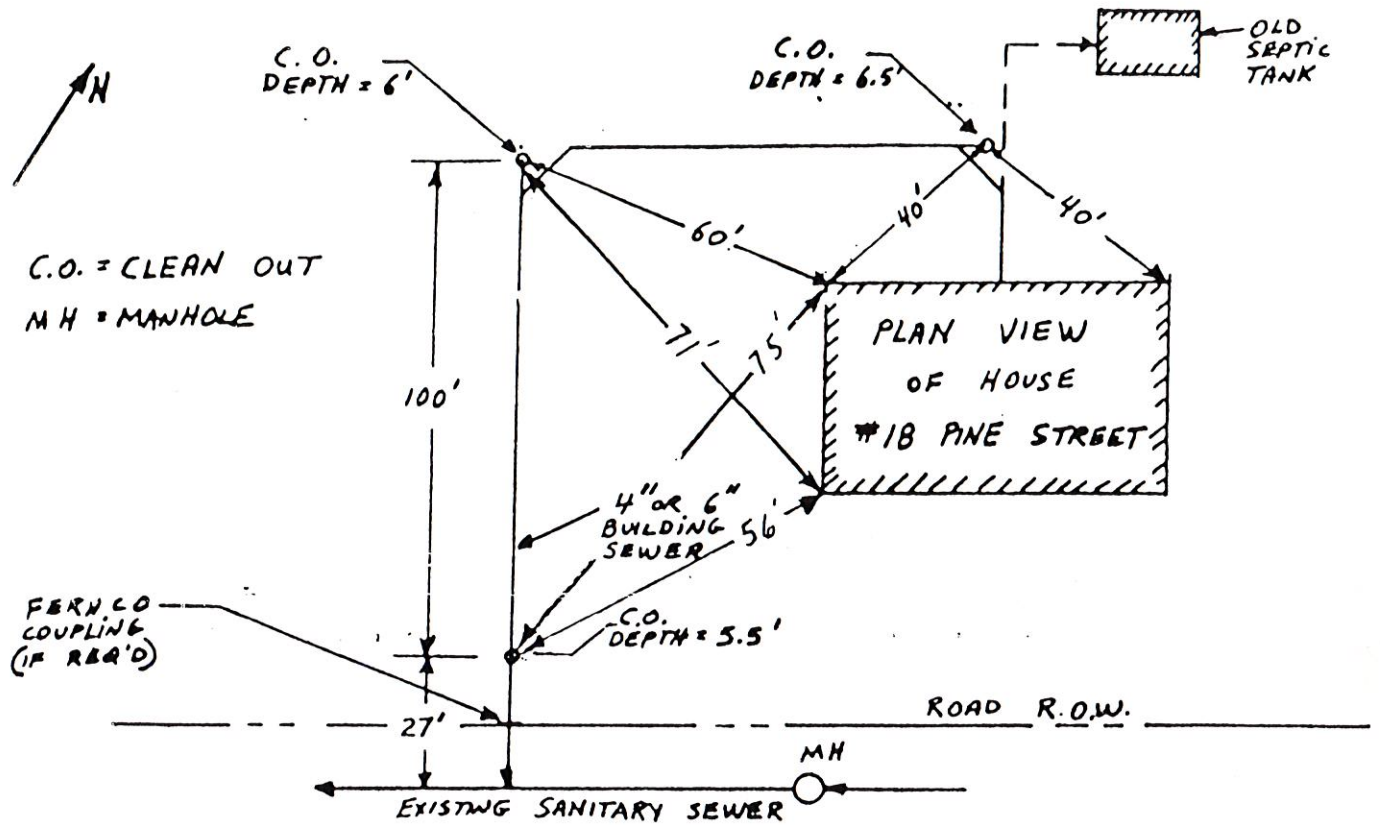

NAME: Harold Wiley  
 ADDRESS: 10 Langmuir Rd.  
 CONTRACTOR: Richard P. Wale

DATE: July 5 1984  
 COLLECTOR OR INTERCEPTOR

By [Signature]

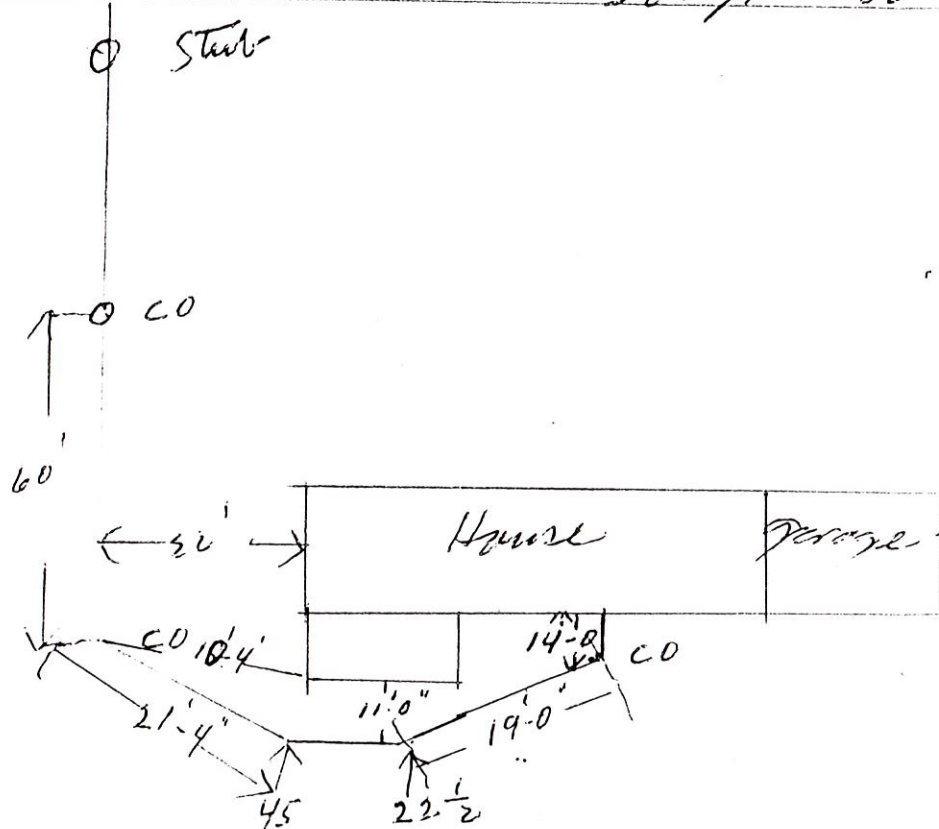

12/88

# SANITARY SEWER SERVICE LOCATION

Town, City of: Cumberland

Date Installed 5-17-83

Street Longmeadow Rd

Type, Size of Service Pipe 6" PVC

Dwelling No. # 11

Connection at Sewer Main TEE

Occupant \_\_\_\_\_

Depth, End of Service Pipe 5.5'

Owner RICHARD KURTZ

Length of Service Pipe Laid 14.5'

C-1-C514

Measured, Located By \_\_\_\_\_

\_\_\_\_\_

Project Contractor S.E. Macmillan

## LOCATION DIAGRAM

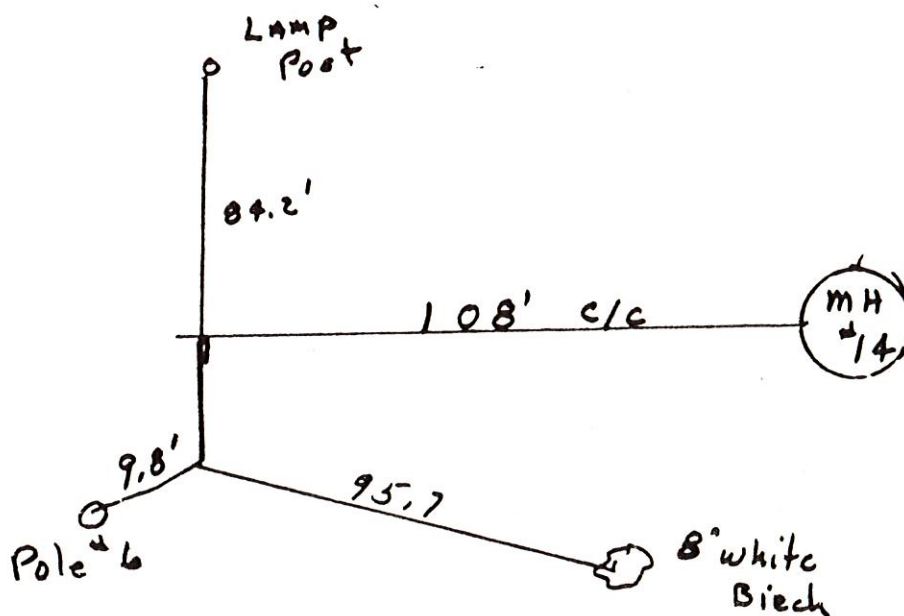

Remarks:

\_\_\_\_\_  
 \_\_\_\_\_  
 \_\_\_\_\_  
 \_\_\_\_\_  
 \_\_\_\_\_



# SANITARY SEWER SERVICE LOCATION

Town, City of: Cumberland

Date Installed 5-17-83

Street Longmeadow Rd

Type, Size of Service Pipe 6" PVC

Dwelling No. # 11

Connection at Sewer Main TEE

Occupant \_\_\_\_\_

Depth, End of Service Pipe 5.5'

Owner R. Kurtz

Length of Service Pipe Laid 14.5'

Measured, Located By \_\_\_\_\_

Project Contractor S.E. Macmillan

## LOCATION DIAGRAM

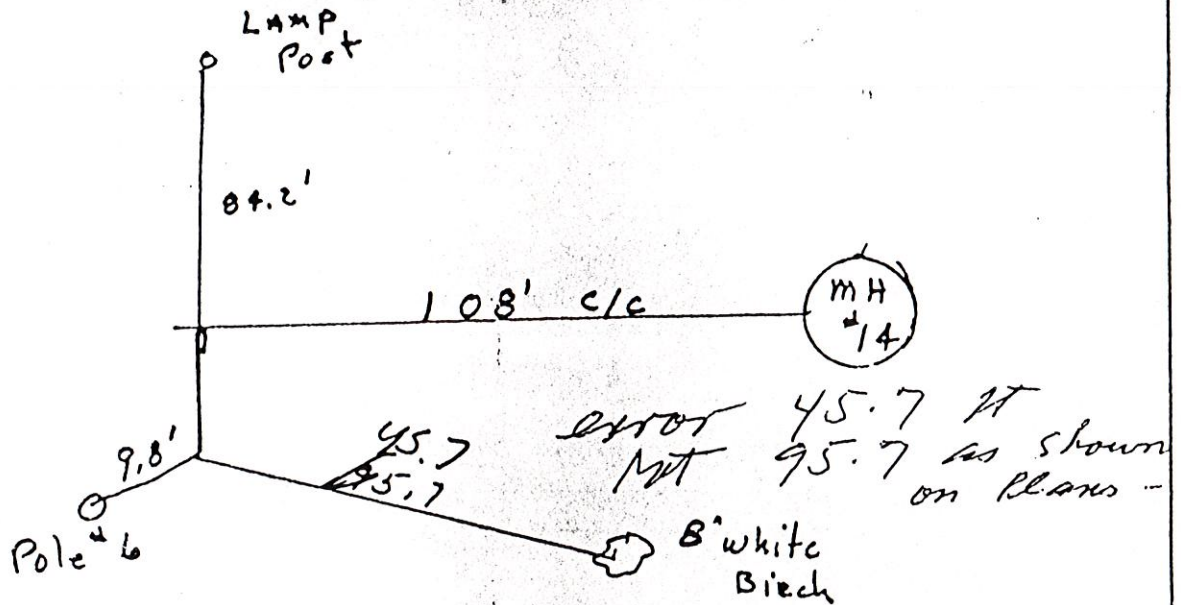

Remarks:

# SANITARY SEWER SERVICE LOCATION

Town, City of: Cumberland

Date Installed 5-17-83

Street Longmeadow Rd

Type, Size of Service Pipe 6" PVC

Dwelling No. # 11

Connection at Sewer Main TEE

Occupant \_\_\_\_\_

Depth, End of Service Pipe 5.5'

Owner \_\_\_\_\_

Length of Service Pipe Laid 14.5'

Measured, Located By \_\_\_\_\_

Project Contractor S.E. Macmillan

## LOCATION DIAGRAM

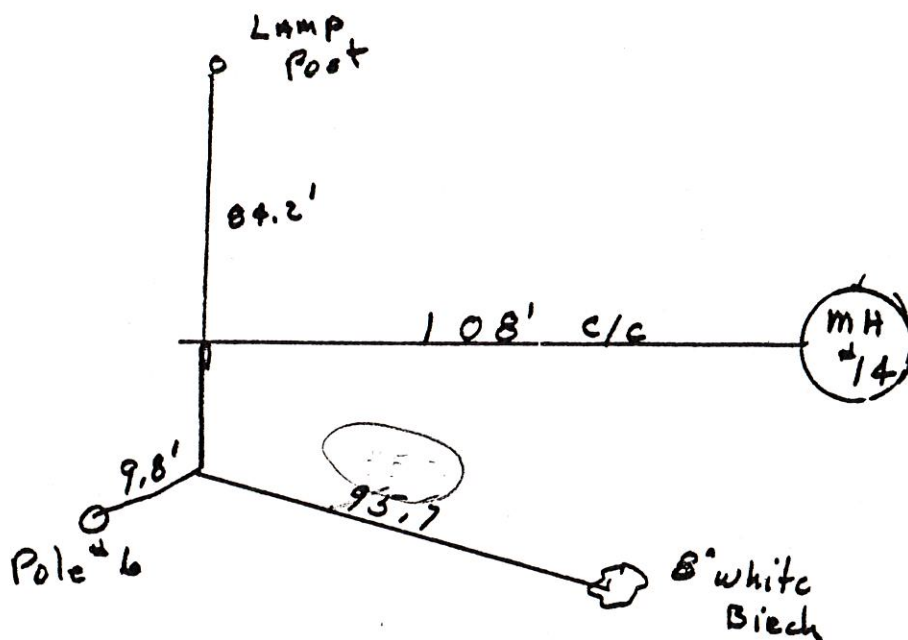

Remarks:

# SAMPLE BUILDING SEWER SKETCH

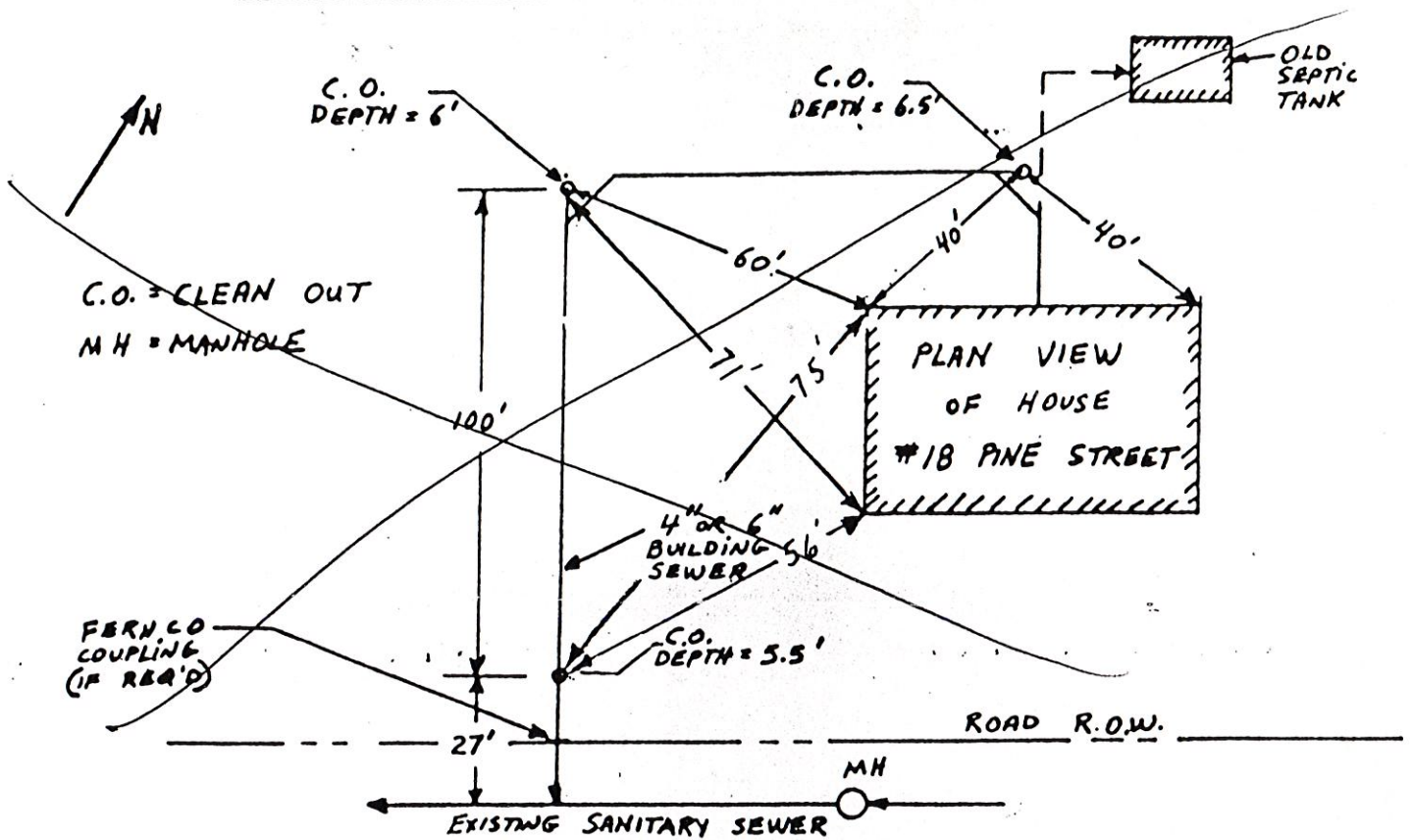

NAME: Richard Kurtz  
 ADDRESS: 11 Longmeadow Rd  
 CONTRACTOR: Richard P. Waetz

DATE: July 6 1984  
 COLLECTOR OR INTERCEPT

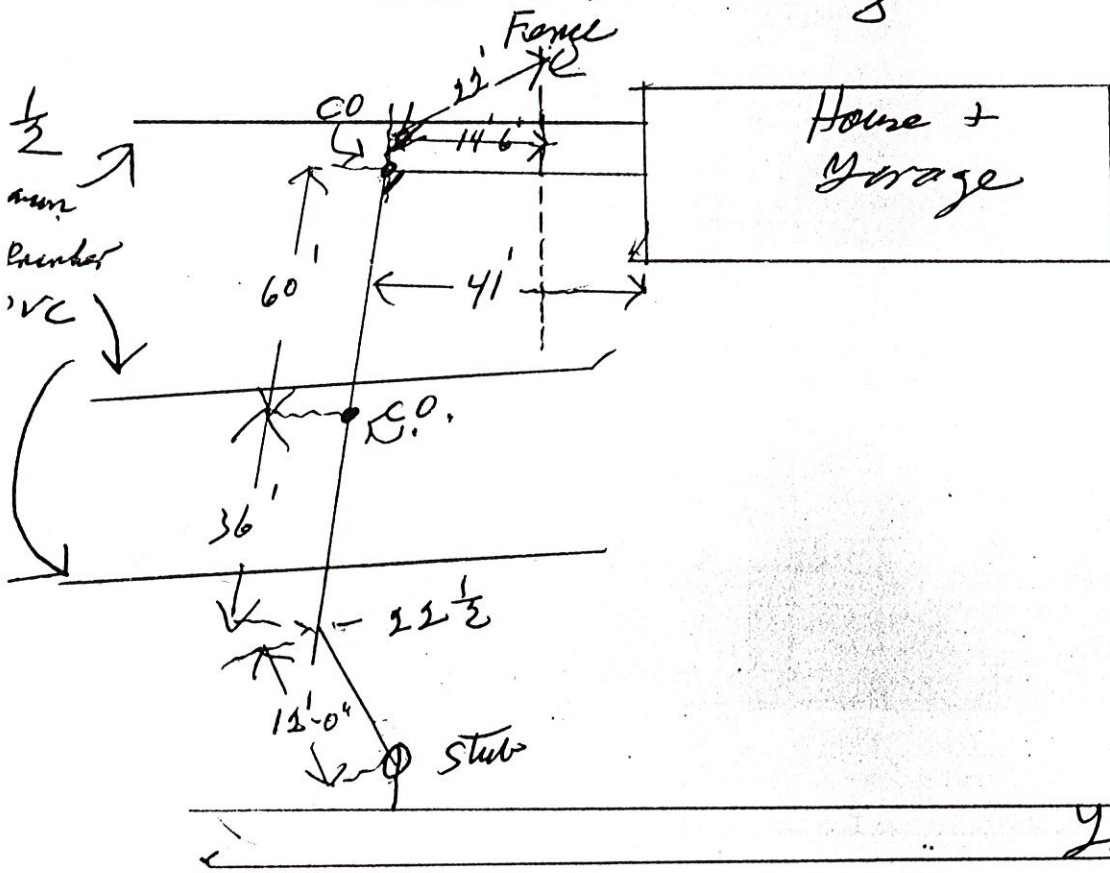

Pt 88



# SANITARY SEWER SERVICE LOCATION

Town, City of: Cumberland

Date Installed \_\_\_\_\_

Street Longmadow

Type, Size of Service Pipe 6" PVC

Dwelling No. # 12

Connection at Sewer Main TEE

Occupant \_\_\_\_\_

Depth, End of Service Pipe \_\_\_\_\_

Owner \_\_\_\_\_

Length of Service Pipe Laid \_\_\_\_\_

Measured, Located By \_\_\_\_\_

Project Contractor \_\_\_\_\_

## LOCATION DIAGRAM

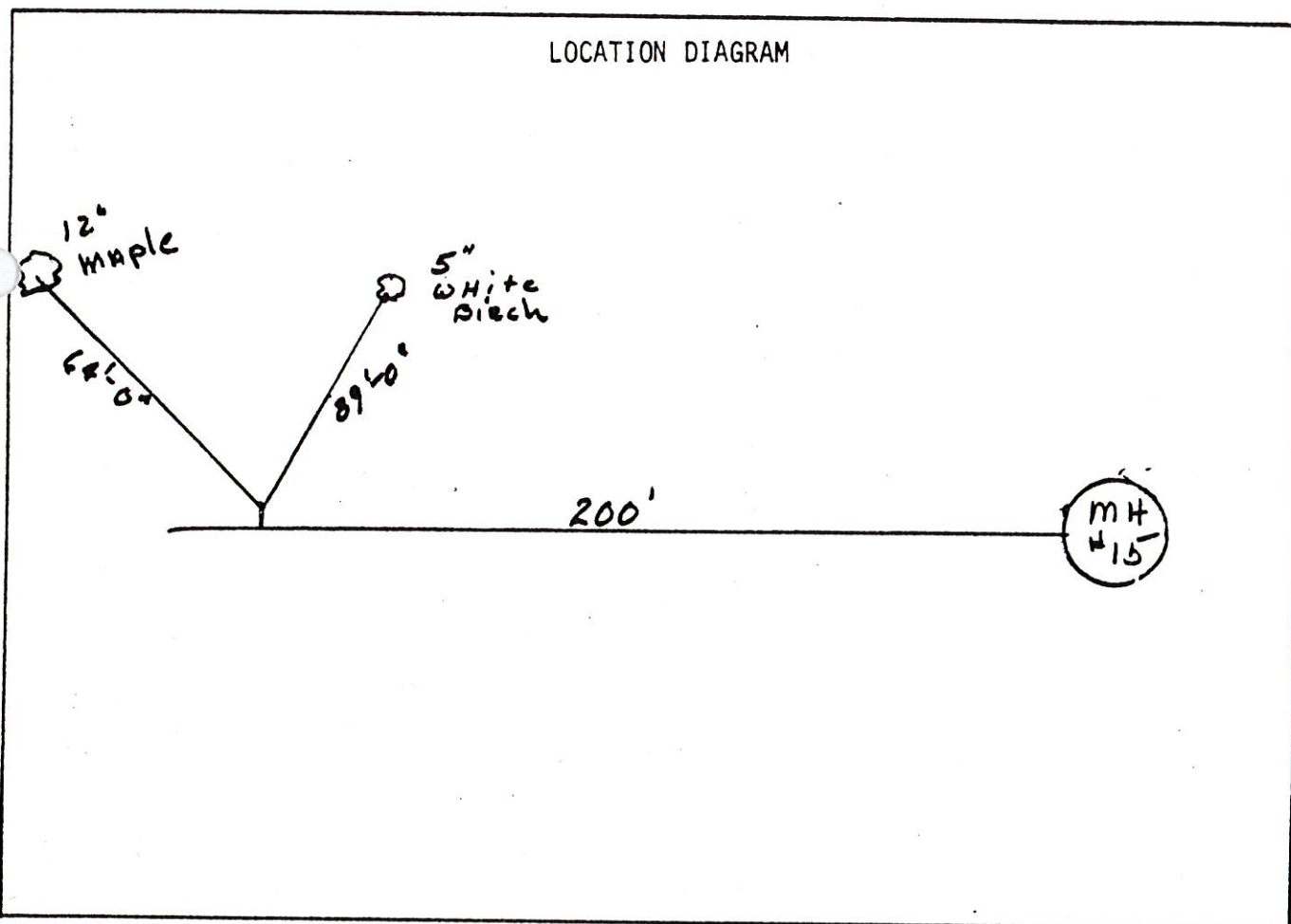

Remarks:

\_\_\_\_\_  
 \_\_\_\_\_  
 \_\_\_\_\_  
 \_\_\_\_\_  
 \_\_\_\_\_

# SANITARY SEWER SERVICE LOCATION

Town, City of: CUMBERLAND

Date Installed JUNE 22, 1983

Street LONG MEADOW RD

Type, Size of Service Pipe 6" PVC

Dwelling No. 10 12

Connection at Sewer Main TEE, MH 3+26+55' Occupant \_\_\_\_\_

Depth, End of Service Pipe 4' DEEP @ 1/4" FOOT Owner HAROLD WILEY

Length of Service Pipe Laid 27' C-1-C1153

Measured, Located By \_\_\_\_\_

Project Contractor S.E. MACMILLAN

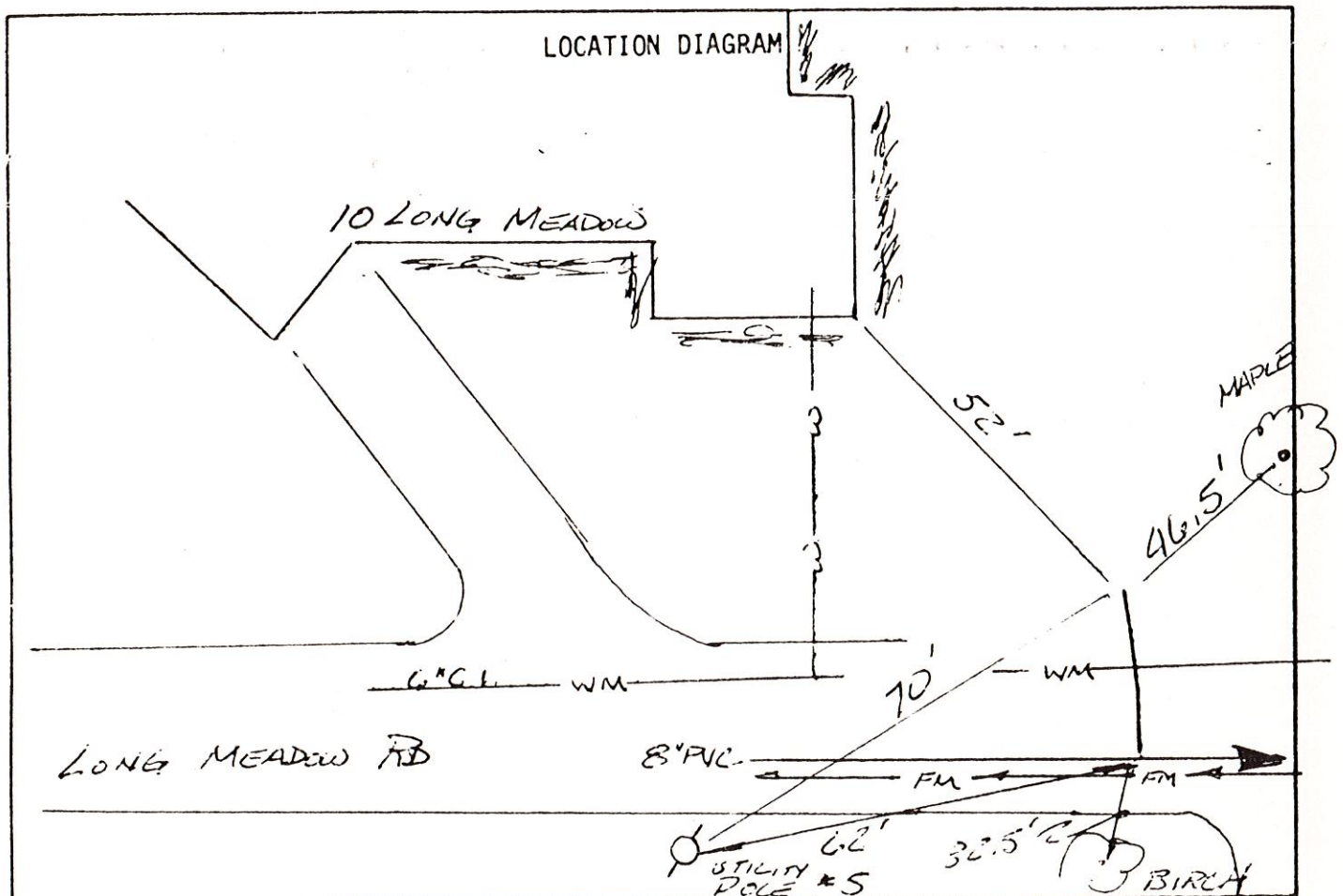

Remarks: 6" PVC OVER 6" WATER MAIN BY 1"

\_\_\_\_\_

\_\_\_\_\_

\_\_\_\_\_

\_\_\_\_\_

# SANITARY SEWER SERVICE LOCATION

Town, City of: CUMBERLAND

Date Installed JUNE 22, 1983

Street LONG MEADOW RD

Type, Size of Service Pipe 6" PVC

Dwelling No. 12

Connection at Sewer Main TEE, MH0100+200'

Occupant \_\_\_\_\_

Depth, End of Service Pipe 5' DEEP @ SLOPE 1/2" / FT

Owner \_\_\_\_\_

Length of Service Pipe Laid 31'

Measured, Located By \_\_\_\_\_

Project Contractor S.E. MACMILLAN

## LOCATION DIAGRAM

12 LONG MEADOW RD

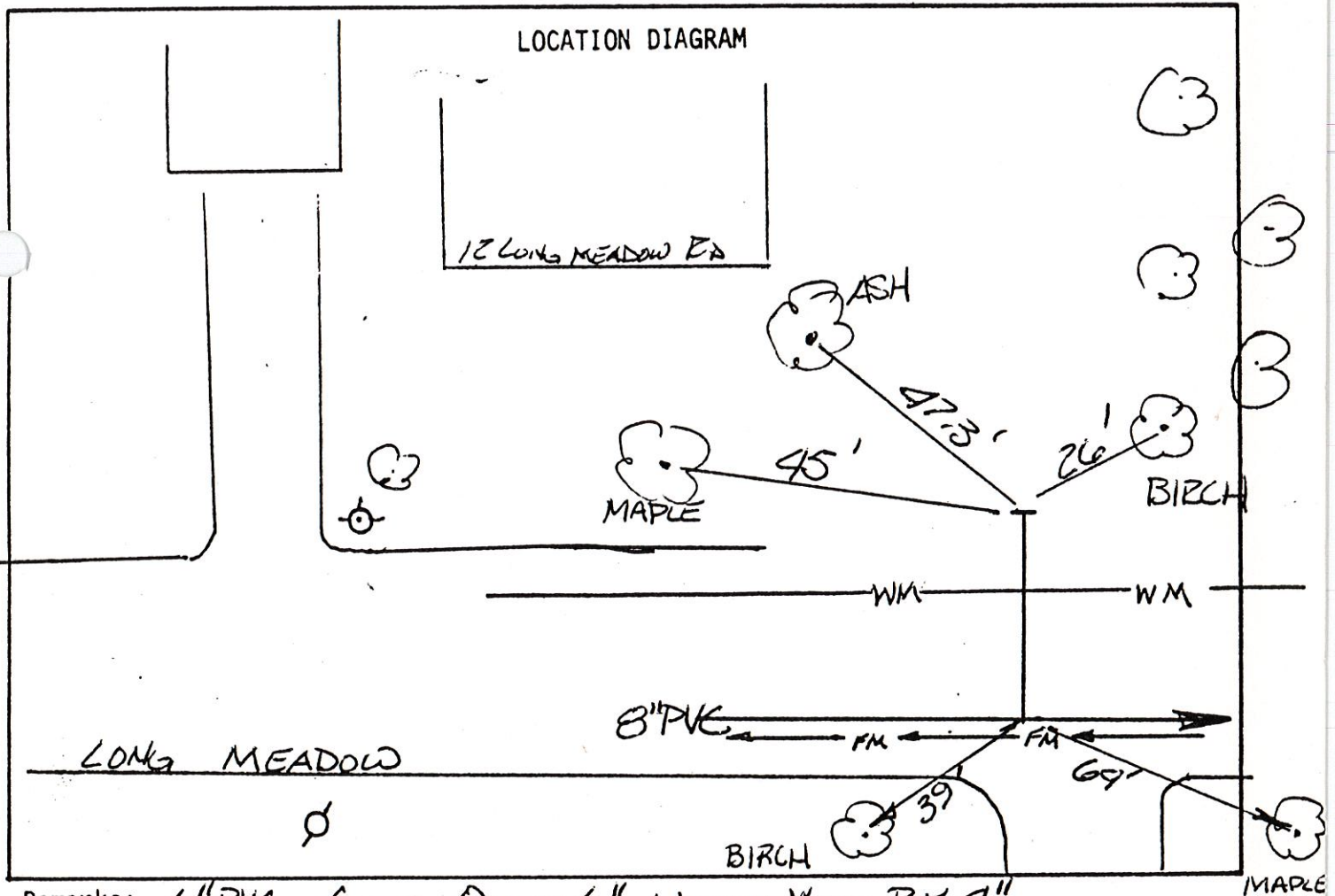

Remarks: 6" PVC GOES OVER 6" WATER MAIN BY 4"



SANITARY SEWER SERVICE LOCATION

Town, City of: Cumberland

Date Installed 5-17-83

Street Longmeadow

Type, Size of Service Pipe 6" PVC

Dwelling No. # 13

Connection at Sewer Main TEE

Occupant \_\_\_\_\_

Depth, End of Service Pipe 5'

Owner Daniel Thurber

Length of Service Pipe Laid 9'-6"

C-1-C1146

Measured, Located By \_\_\_\_\_

\_\_\_\_\_

Project Contractor S.E. MacMillan

LOCATION DIAGRAM

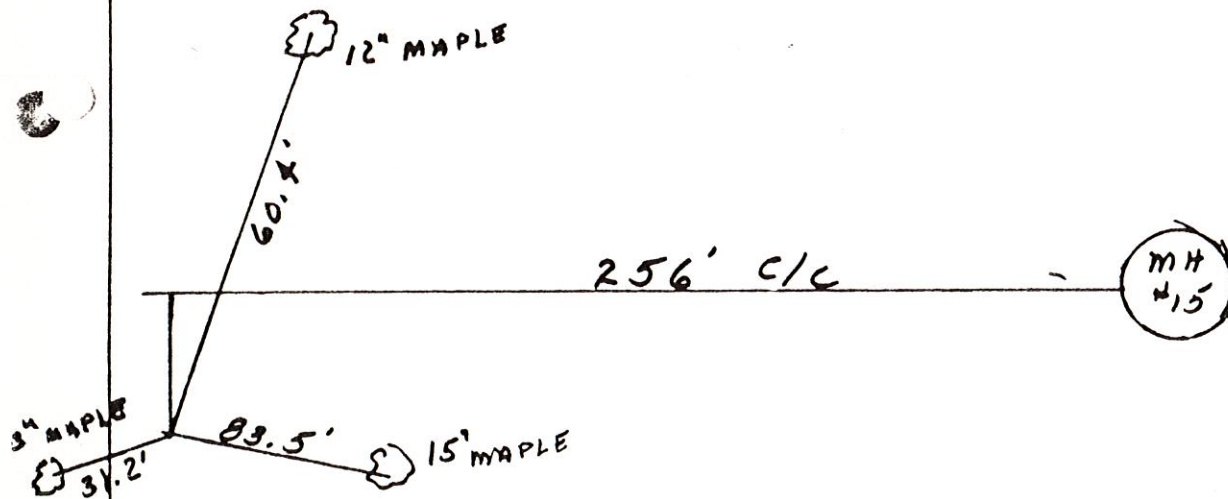

Remarks:

\_\_\_\_\_  
 \_\_\_\_\_  
 \_\_\_\_\_  
 \_\_\_\_\_  
 \_\_\_\_\_

# SANITARY SEWER SERVICE LOCATION

Town, City of: Cumberland

Date Installed 5-17-83

Street Longmeadow

Type, Size of Service Pipe 6" PVC

Dwelling No. # 13

Connection at Sewer Main TEE

Occupant \_\_\_\_\_

Depth, End of Service Pipe 5'

Owner \_\_\_\_\_

Length of Service Pipe Laid 9'-6"

Measured, Located By \_\_\_\_\_

Project Contractor \_\_\_\_\_

## LOCATION DIAGRAM

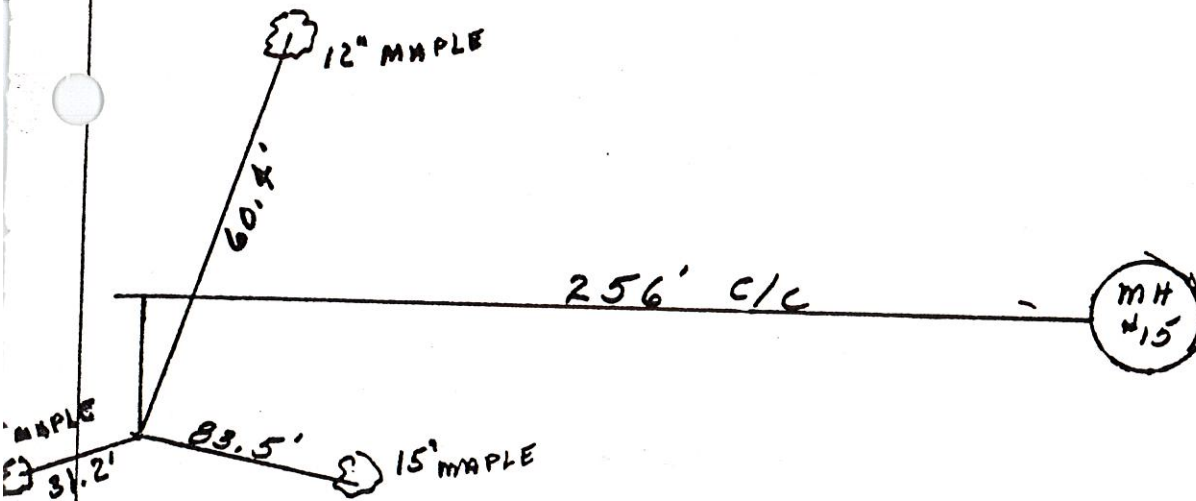

Remarks:

\_\_\_\_\_  
 \_\_\_\_\_  
 \_\_\_\_\_  
 \_\_\_\_\_  
 \_\_\_\_\_

# SAMPLE BUILDING SEWER SKETCH

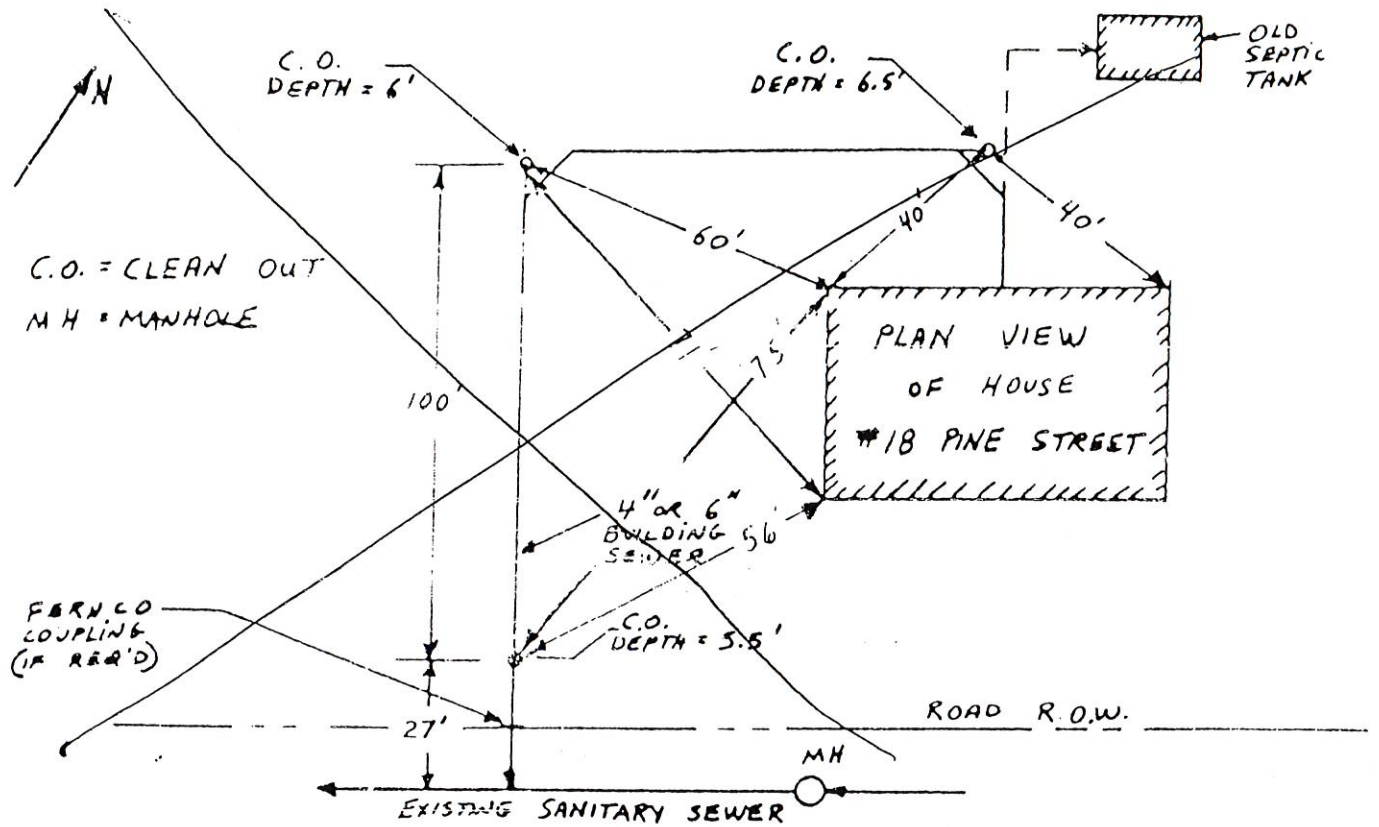

NAME: Daniel THURBOR  
 ADDRESS: 13 Long meadow  
 CONTRACTOR: Richard P. Wack

DATE: July 2 - 1984  
 COLLECTOR OR INTERCEPT

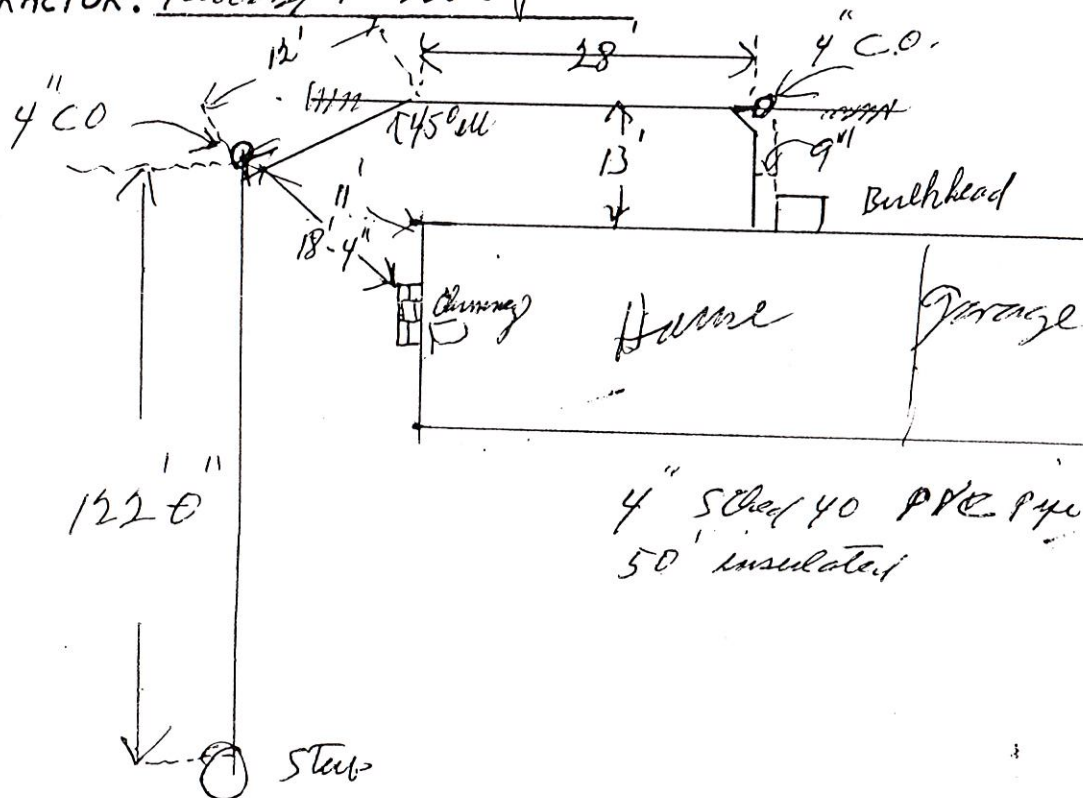

Long meadow



Town, City of: CUMBERLAND

Street LONG MEADOW RD

Dwelling No. 1715

Occupant

Owner Robert Robinson

---

\_\_\_\_\_

S.E. MACMILLAN



17 LONG MEADOW

6" PINE

6" C.M.P.

200

97.3'

UTILITY  
POLE

8" PVC

TO RBE

LONG MEADOW RD

WM - 6" G.I. J

Remarks:

MAPLE

MAPLE

# SANITARY SEWER SERVICE LOCATION

Town, City of: CUMBERLAND

Date Installed JUNE 21, 1983

Street LONG MEADOW RD

Type, Size of Service Pipe 6" PVC

Dwelling No. 17 15

Connection at Sewer Main WYE, MH 0+00+26'

Occupant \_\_\_\_\_

Depth, End of Service Pipe 6" @ SLOPE 1/2" / FOOT

Owner THOMAS J. JAMES

Length of Service Pipe Laid 24' of 6" PVC

Measured, Located By DAN MCKAY

Project Contractor S.E. MACMILLAN

## LOCATION DIAGRAM

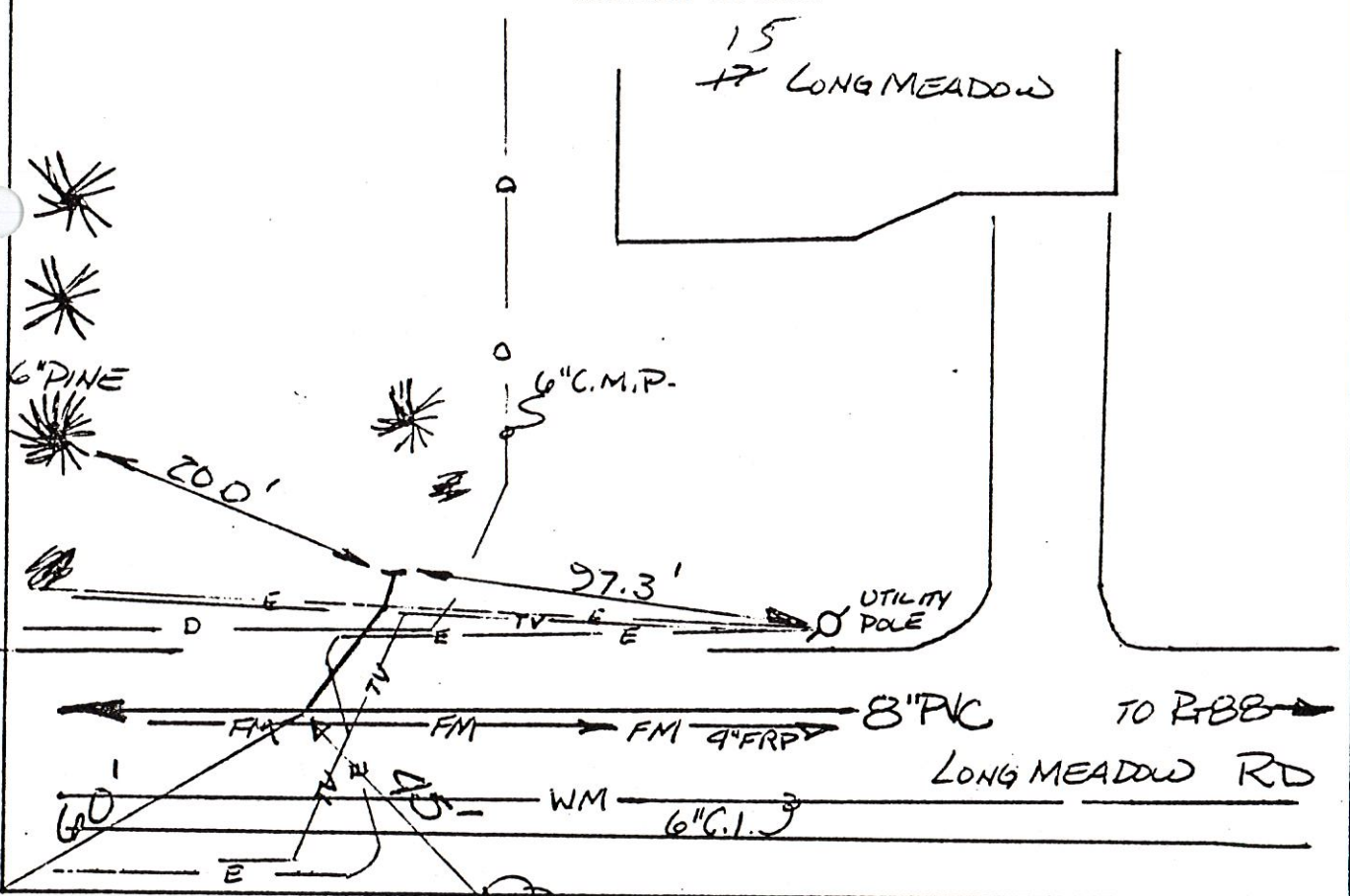

Remarks: \_\_\_\_\_

\_\_\_\_\_

\_\_\_\_\_

\_\_\_\_\_

\_\_\_\_\_



# SAMPLE BUILDING SEWER SKETCH

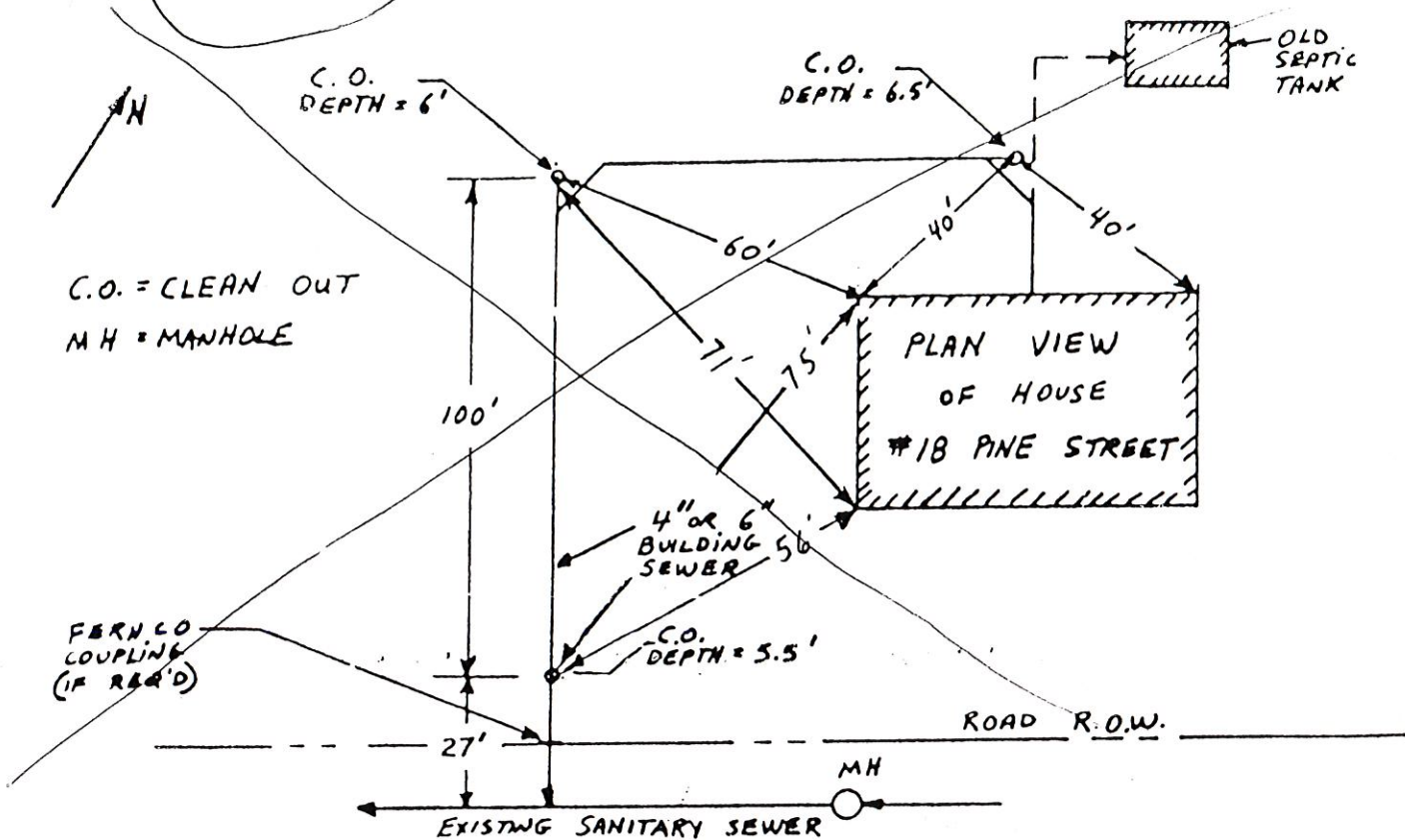

NAME: Robert Robinson  
 ADDRESS: 15 Long meadow Rd  
 CONTRACTOR: Richard P. Waltz

DATE: July 3-1989  
 COLLECTOR OR INTERCEPTOR

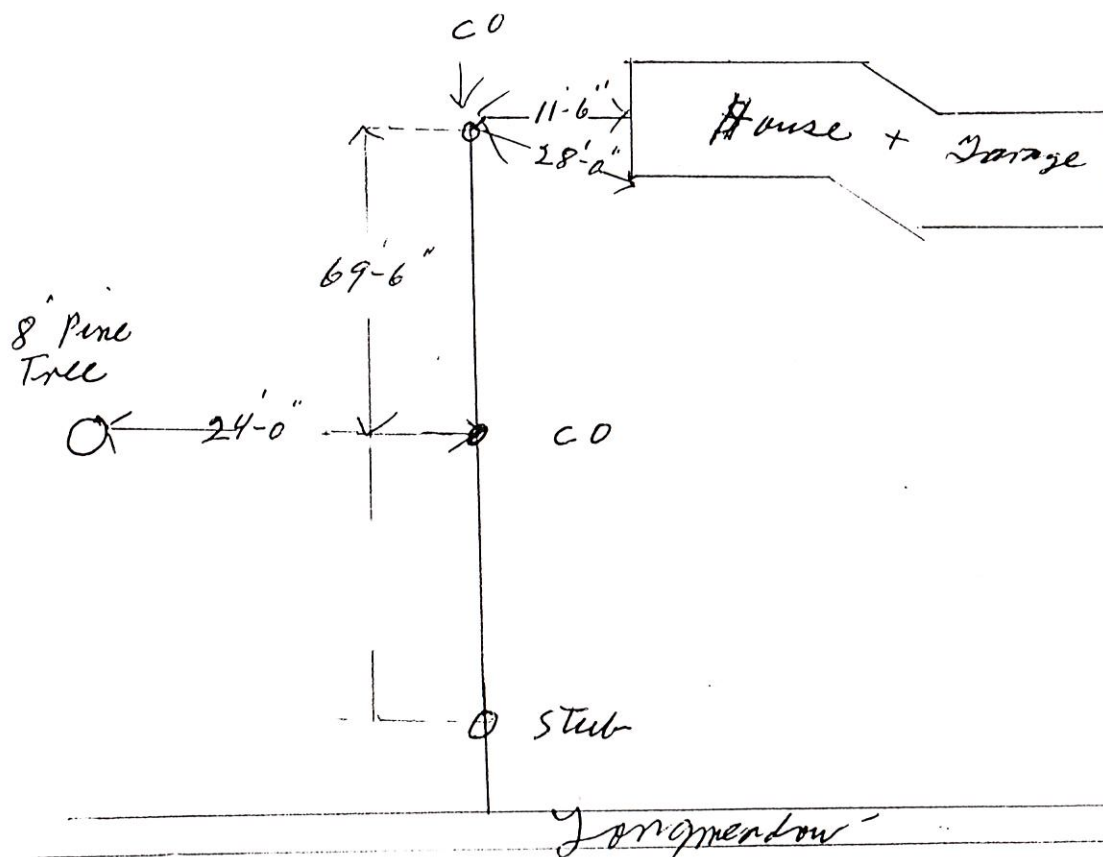

RT  
 88



# SANITARY SEWER SERVICE LOCATION

Town, City of: Cumberland

Date Installed \_\_\_\_\_

Street Longmeadow

Type, Size of Service Pipe 6" PVC

Dwelling No. # 17 15

Connection at Sewer Main WYE

Occupant \_\_\_\_\_

Depth, End of Service Pipe \_\_\_\_\_

Owner \_\_\_\_\_

Length of Service Pipe Laid \_\_\_\_\_

Measured, Located By \_\_\_\_\_

Project Contractor \_\_\_\_\_

LOCATION DIAGRAM

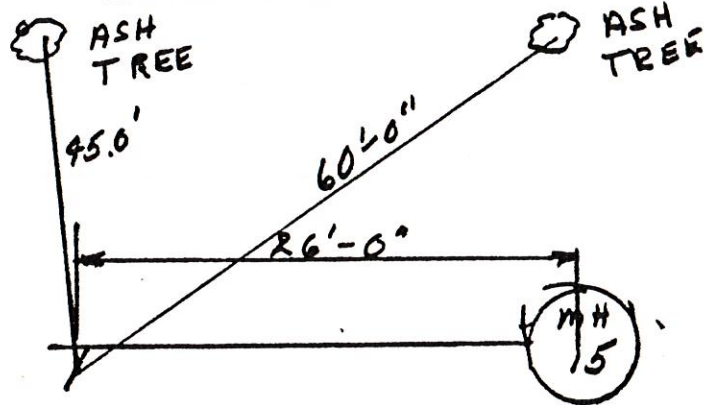

Remarks:

\_\_\_\_\_  
 \_\_\_\_\_  
 \_\_\_\_\_  
 \_\_\_\_\_  
 \_\_\_\_\_

# SANITARY SEWER SERVICE LOCATION

Town, City of: CUMBERLAND

Date Installed JUNE 22, 1983

Street LONG MEADOW RD

Type, Size of Service Pipe 6" PVC

Dwelling No. 12 16

Connection at Sewer Main TEE, MH0+100+200'

Occupant \_\_\_\_\_

Depth, End of Service Pipe 5' DEEP SIDE 1/2" / FT

Owner Robert McNaboe

Length of Service Pipe Laid 31'

Measured, Located By \_\_\_\_\_

Project Contractor S.E. MACMILLAN

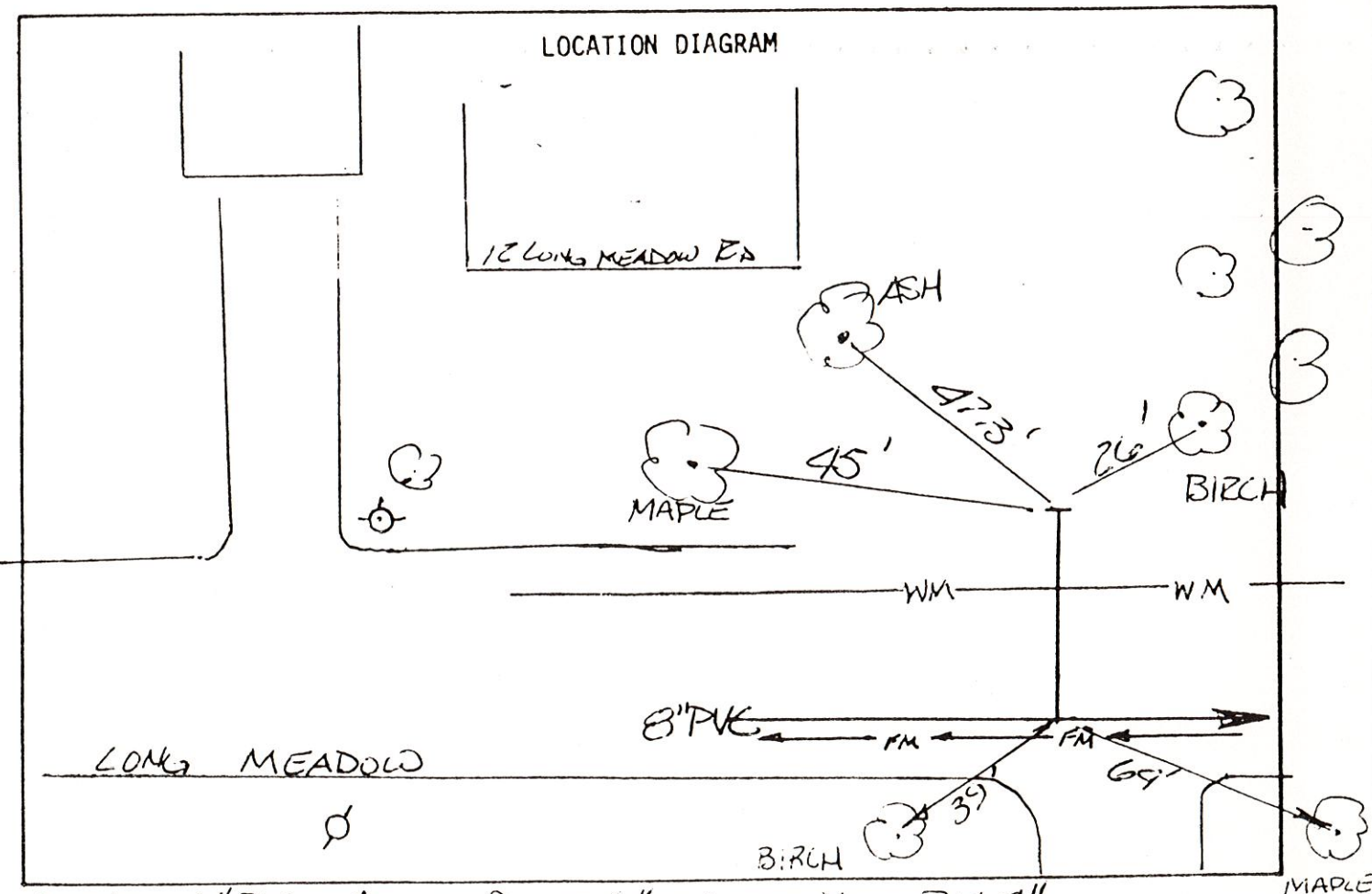

Remarks: 6" PVC GOES OVER 6" WATER MAIN BY 4"

\_\_\_\_\_  
 \_\_\_\_\_  
 \_\_\_\_\_  
 \_\_\_\_\_

# SANITARY SEWER SERVICE LOCATION

Town, City of: CUMBERLAND

Date Installed JUNE 22, 1983

Street LONG MEADOW RD

Type, Size of Service Pipe 6" PVC

Dwelling No. 12 16 D.N.V.

Connection at Sewer Main TEE, MH0100+200'

Occupant \_\_\_\_\_

Depth, End of Service Pipe 5' DEEP @ 1/2" / FT

Owner \_\_\_\_\_

Length of Service Pipe Laid 31'

Measured, Located By \_\_\_\_\_

Project Contractor S.E. MACMILLAN

LOCATION DIAGRAM

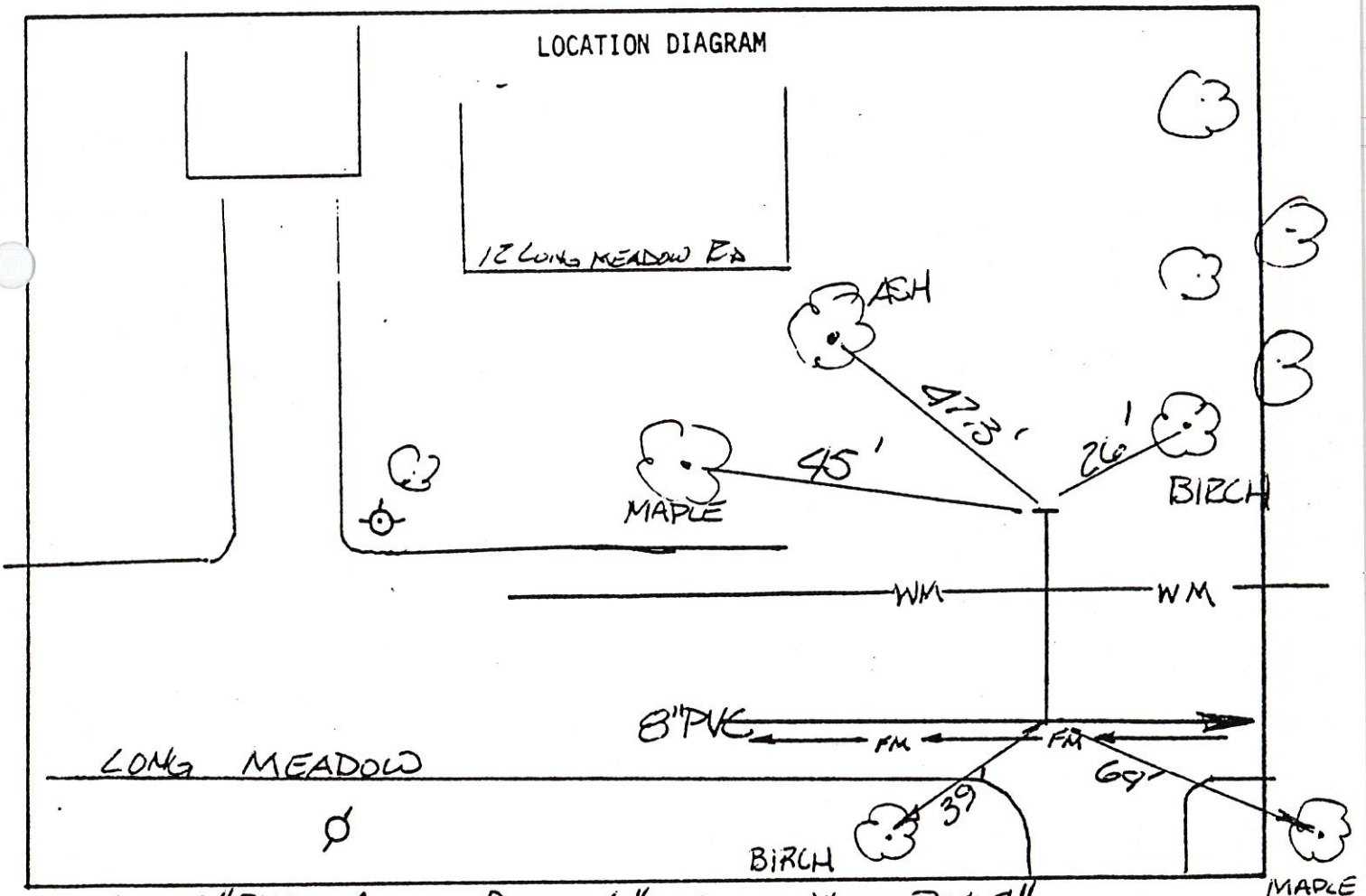

Remarks: 6" PVC GOES OVER 6" WATER MAIN BY 4"



# SAMPLE BUILDING SEWER SKETCH

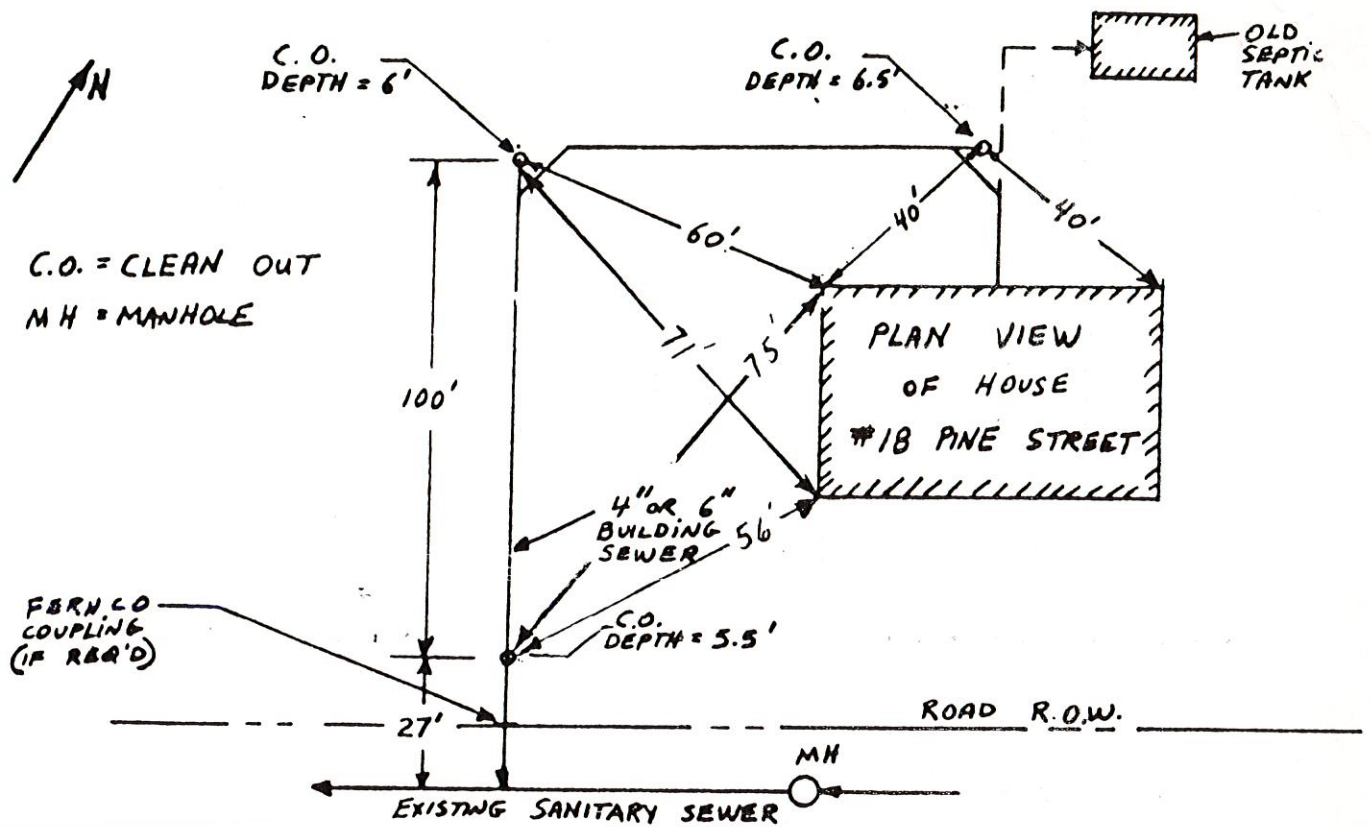

NAME: Marnie M. Noble  
 ADDRESS: 16 Longmeadow Rd  
 CONTRACTOR: Richard P. Wacht

DATE: July 6-1984  
 COLLECTOR OR INTERCEPT

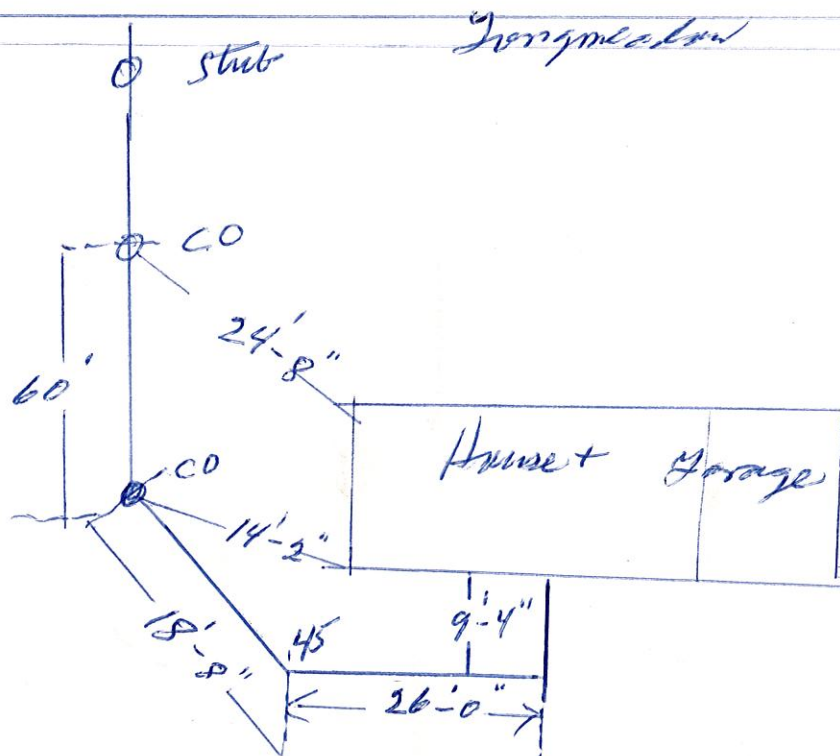

Rt  
89

# SANITARY SEWER SERVICE LOCATION

Town, City of: CUMBERLAND

Date Installed JUNE 21, 1983

Street LONG MEADOW RD

Type, Size of Service Pipe 6" PVC

Dwelling No. 19 or 17

Connection at Sewer Main TEE, MH0+00+5'

Occupant J.G. [unclear]

Depth, End of Service Pipe 2' @ MINIMUM SLOPE

Owner \_\_\_\_\_

Length of Service Pipe Laid 93.5'

Measured, Located By \_\_\_\_\_

Project Contractor S.E. MACMILLAN

LOCATION DIAGRAM

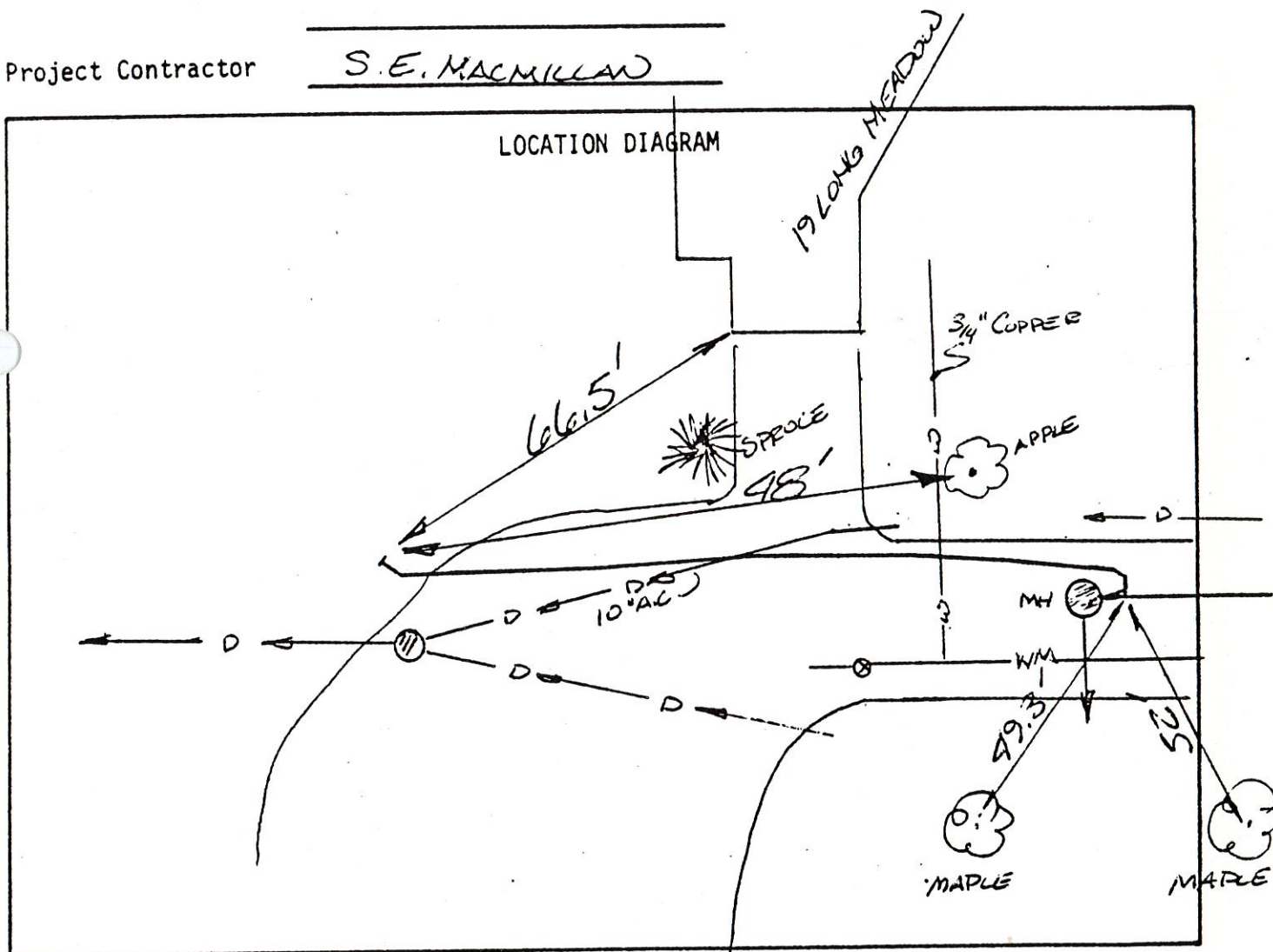

Remarks: OWNER WILL NEED PUMP TO UTILIZE SERVICE - 6" PVC  
GOES OVER 3/4" WATERLINE & 10" DRAIN LINE



# SAMPLE BUILDING SEWER SKETCH

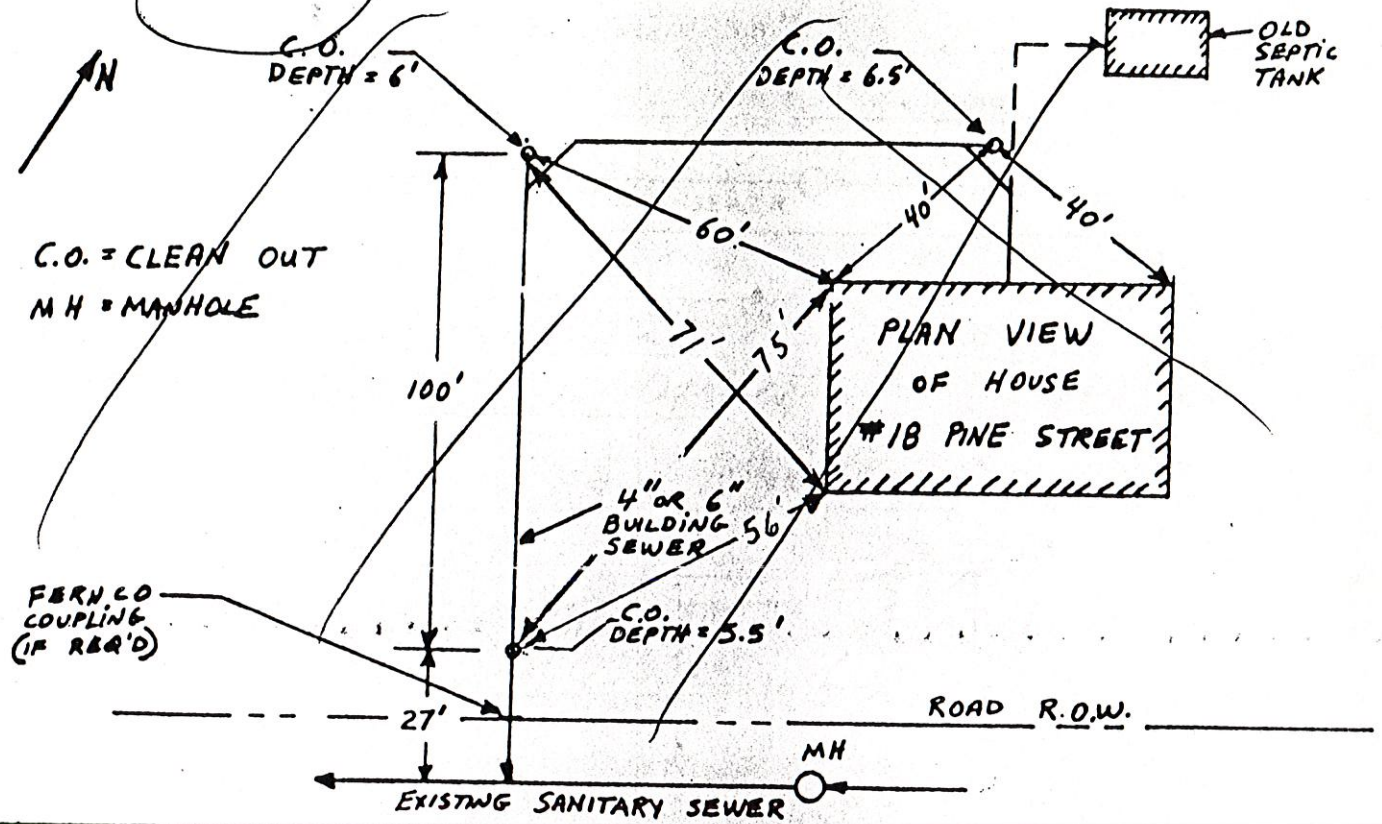

NAME: John Keenan  
 ADDRESS: 18 Longmeadow  
 CONTRACTOR: Richard P. Wacht

DATE: July 9  
 COLLECTOR OR INTERCEPTO

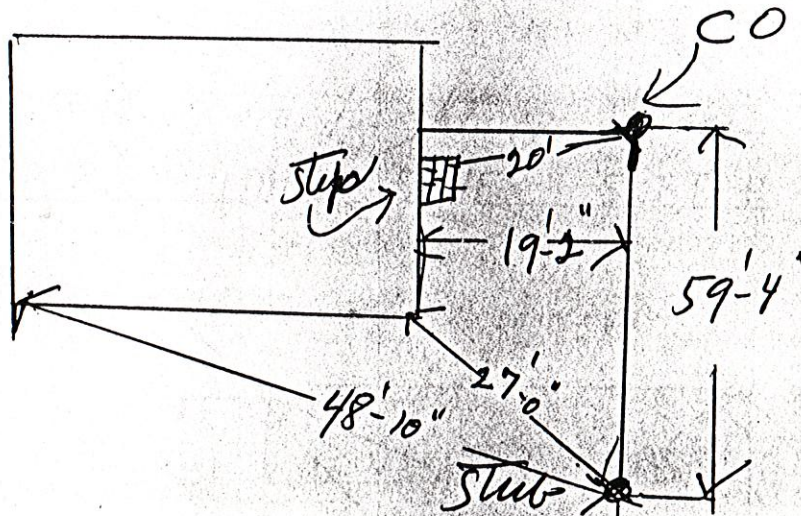

See  
 Cove  
 4" Sched 40 P.V.C.



SANITARY SEWER SERVICE LOCATION

Town, City of: Cumberland

Date Installed \_\_\_\_\_

Street Longmeadow Rd.

Type, Size of Service Pipe 6" PVC

Dwelling No. 19

Connection at Sewer Main TEE

Occupant \_\_\_\_\_

Depth, End of Service Pipe \_\_\_\_\_

Owner \_\_\_\_\_

Length of Service Pipe Laid \_\_\_\_\_

Measured, Located By \_\_\_\_\_

Project Contractor S.E. MacMillan

LOCATION DIAGRAM

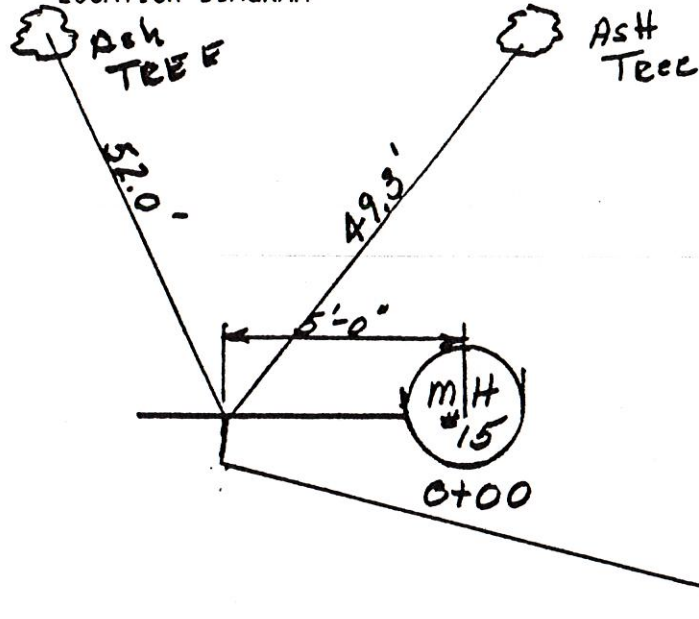

Remarks:

\_\_\_\_\_  
 \_\_\_\_\_  
 \_\_\_\_\_  
 \_\_\_\_\_  
 \_\_\_\_\_

# SAMPLE BUILDING SEWER SKETCH

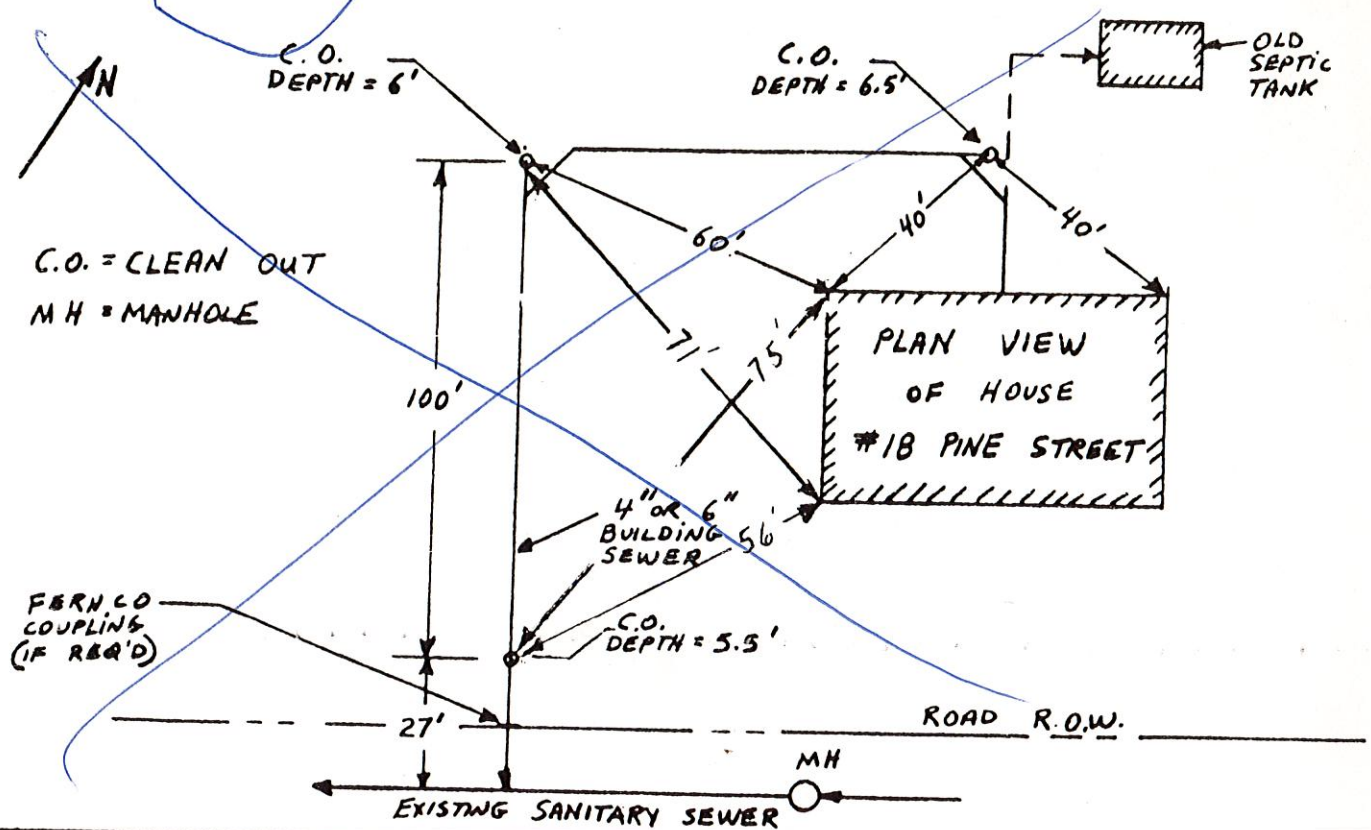

NAME: Gordon Woodward

ADDRESS: 19 Longmeadow Rd

CONTRACTOR: Richard P. Jones

DATE: July 23 1984  
COLLECTOR OR INTERCEPT

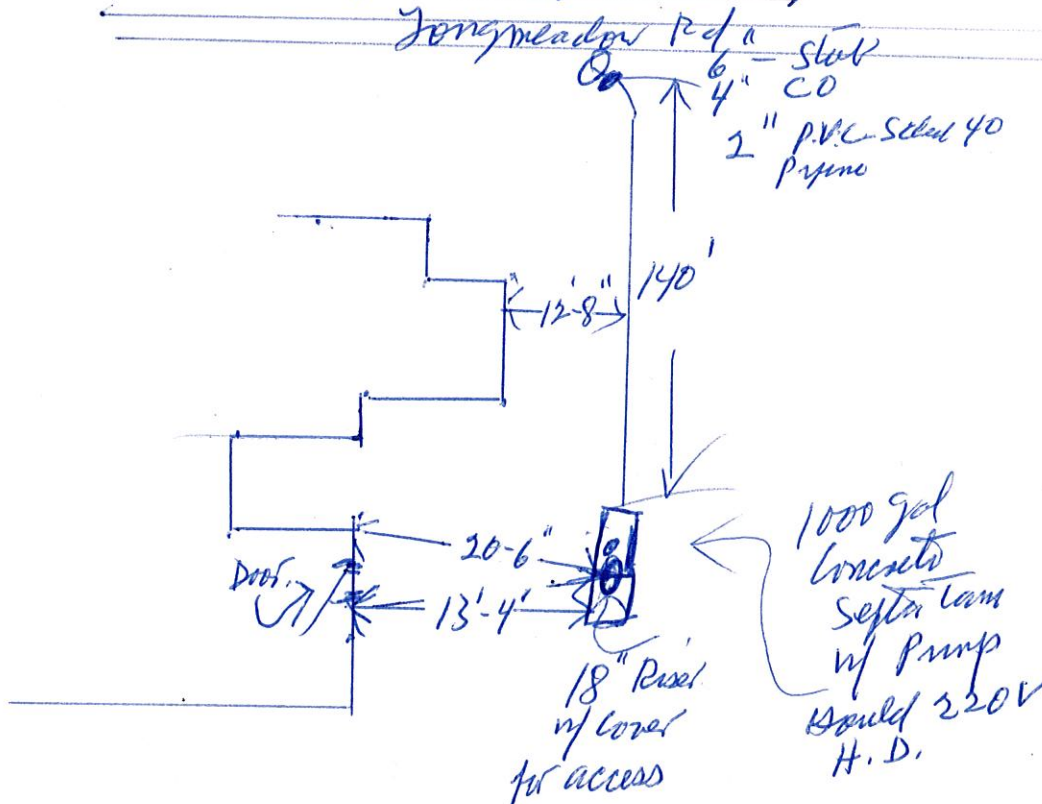

# SANITARY SEWER SERVICE LOCATION

Town, City of: CUMBERLAND, Me.

Date Installed 9-19-83

Street ~~Long~~ SEACOVE X-COUNTRY

Type, Size of Service Pipe 6" PVC

Dwelling No. 420 LONGMEADOW

Connection at Sewer Main Tee

Occupant \_\_\_\_\_

Depth, End of Service Pipe 7'

Owner \_\_\_\_\_

Length of Service Pipe Laid 12.5'

Measured, Located By JA & KB

Project Contractor R.T. GRUNDIN & SONS

LOCATION DIAGRAM

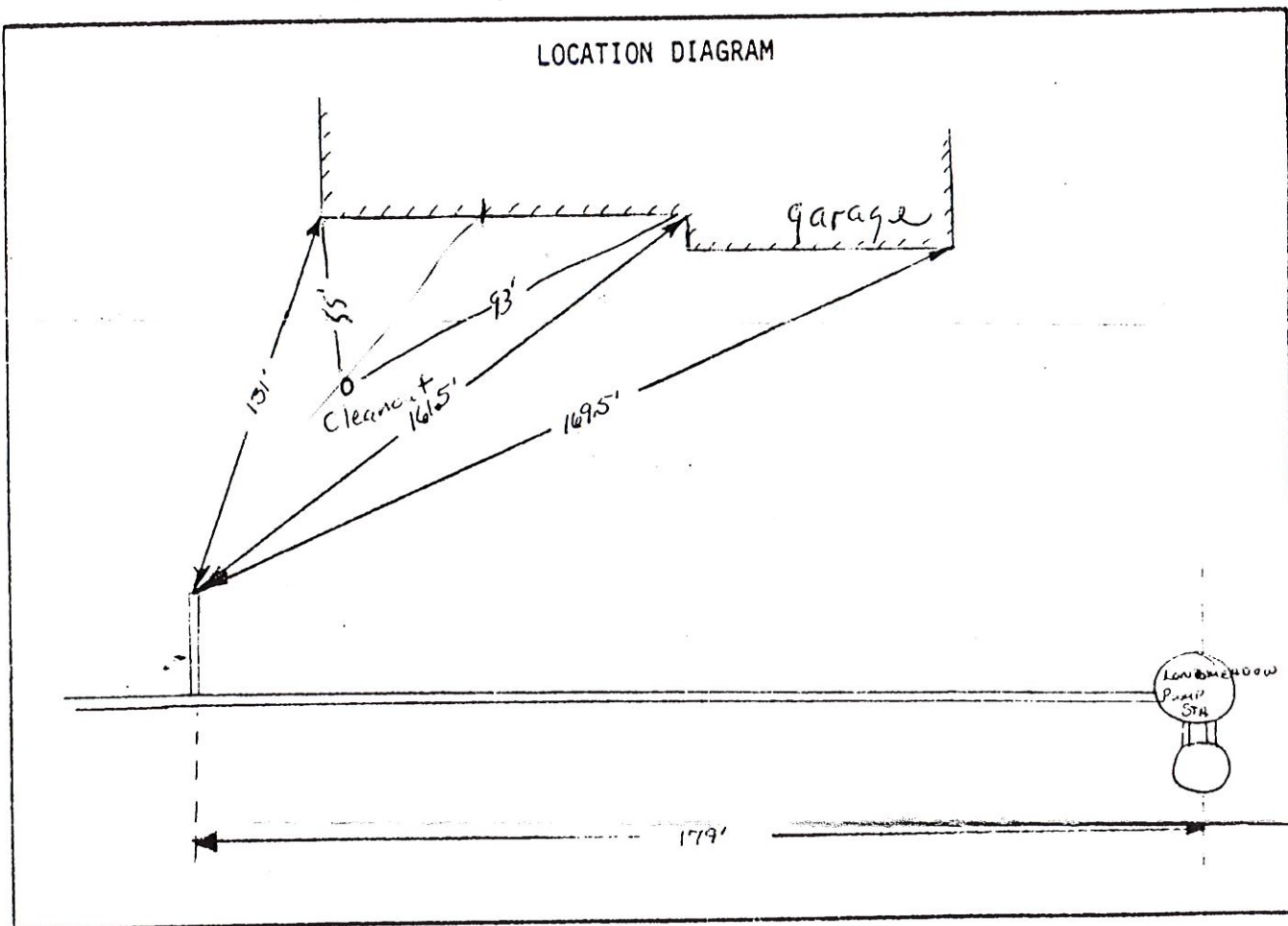

Remarks:



# SANITARY SEWER SERVICE LOCATION

Town, City of: Cumberland

Installed 5-20-83

Street Longmeadow - Rt 88

Type, Size of Service Pipe 6" PVC

Dwelling No #57 Farside Rd.

Connection at Sewer Main WYE

Occupant \_\_\_\_\_

Depth, End of Service Pipe 5'

Owner E. Woodward

Length of Service Pipe Laid 13'-0

Measured, Located By \_\_\_\_\_

Project Contractor S.E. MacMillan

LOCATION DIAGRAM

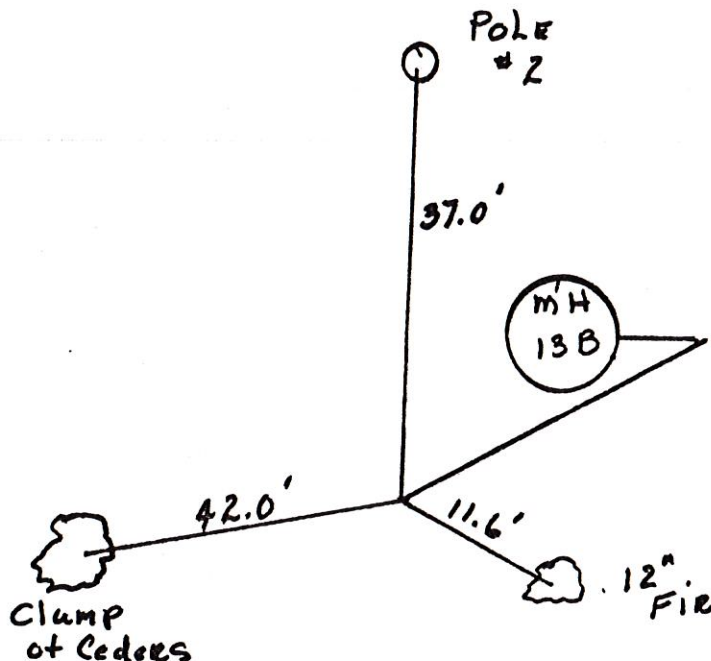

Remarks:

# SANITARY SEWER SERVICE LOCATION

Town, City of: Cumberland

Installed 5-20-83

Type, Size of Service Pipe 6" PVC

Connection at Sewer Main 6YE

Depth, End of Service Pipe 5'

Length of Service Pipe Laid 13'-0

Measured, Located By \_\_\_\_\_

Street Longmeadows

Dwelling No #57 Farside Rd.

Occupant \_\_\_\_\_

Owner E. Woodward

Project Contractor S.E. MacMillan

LOCATION DIAGRAM

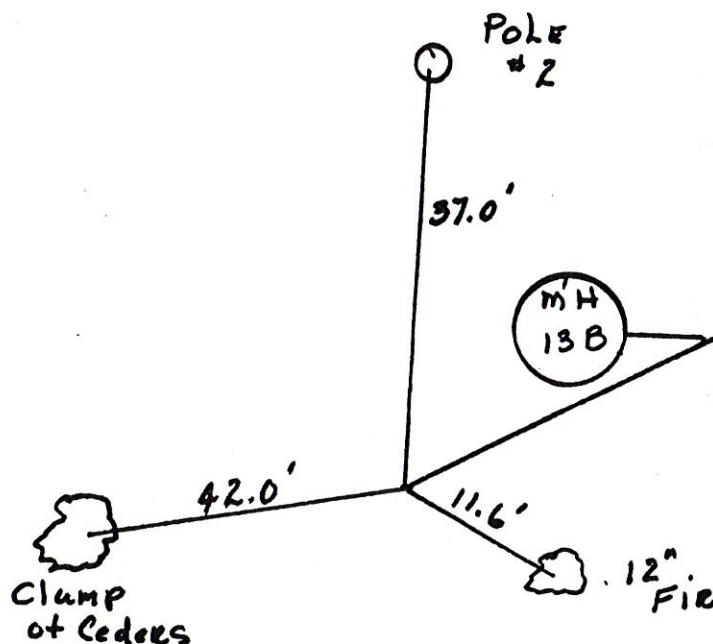

Remarks: