

SANITARY SEWER SERVICE LOCATION

Town, City of: Cumberland

Date Installed 9-15-83

Street Pine Lane

Type, Size of Service Pipe 6" PVC

Dwelling No. #7 Concord Circle

Connection at Sewer Main TEE

Occupant _____

Depth, End of Service Pipe 5.0

Owner _____

Length of Service Pipe Laid 147'

Measured, Located By G.B. & J.T.

Project Contractor R.J. Grondin & Sons

LOCATION DIAGRAM

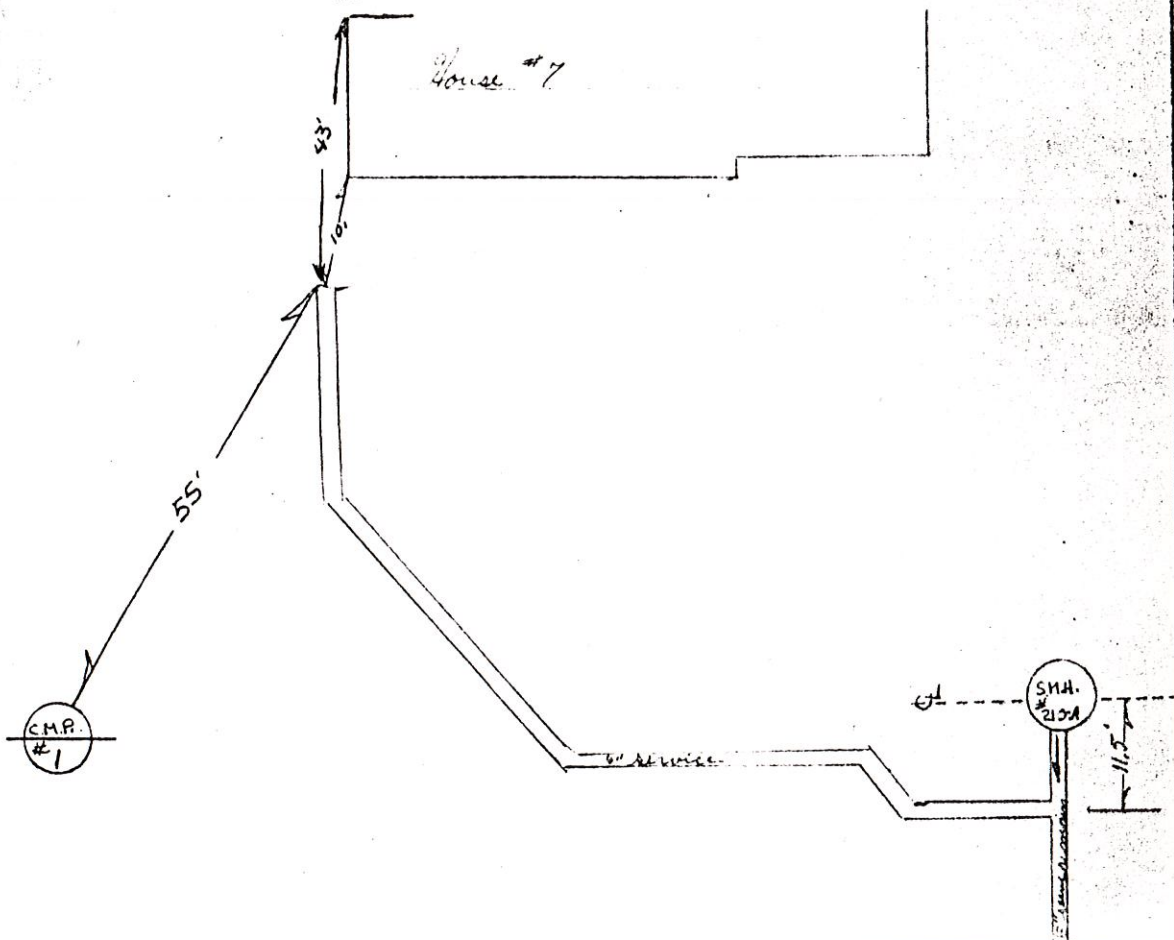

Remarks:

SANITARY SEWER SERVICE LOCATION

Town, City of: Cumberland

Date Installed 9-15-83

Street Pine Lane

Type, Size of Service Pipe 6" PVC

Dwelling No. # 7 Concord Circle

Connection at Sewer Main TEE

Occupant Norman E.

Depth, End of Service Pipe 5.0

Owner Lucy L. Leighton

Length of Service Pipe Laid 147'

C-2-45160

Measured, Located By R.C. & J.T.

Project Contractor R. Goudin & Sons

LOCATION DIAGRAM

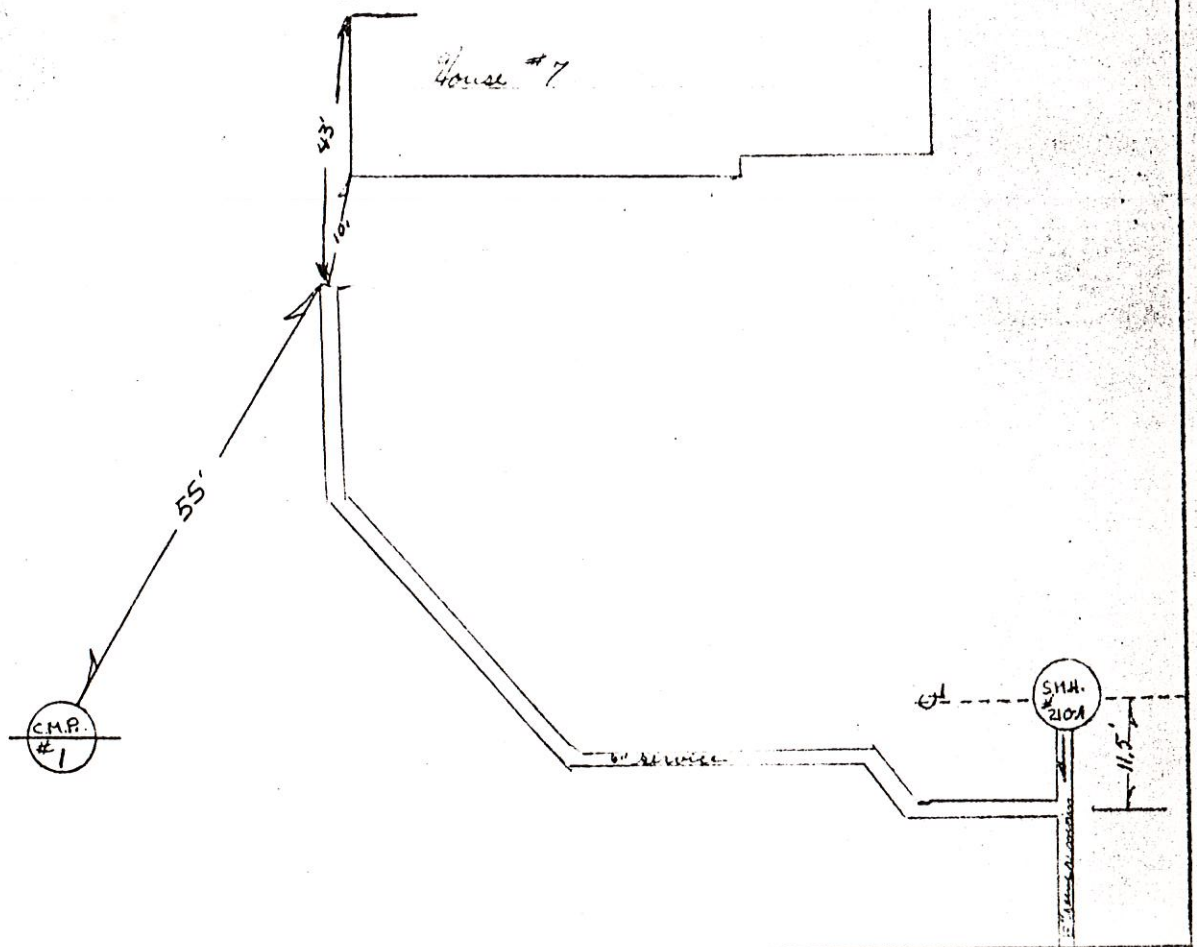

Remarks:

CONTRACTOR: Scott Dugas

COLLECTOR OR INTERCEPT

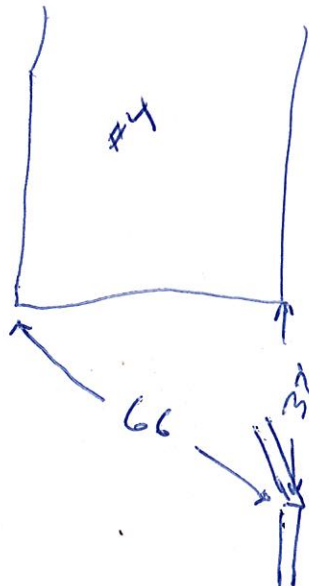

Birch LW