

SANITARY SEWER SERVICE LOCATION

Town, City of : CUMBERLAND

Date Installed: 10-10-18

Street: MAIN ST (RT. 9)

Type, Size of Service Pipe: HDPE, ~~12~~ 2"

Dwelling No. STOCKHOLM DRIVE

Connection at Sewer Main: 3"x2" TEE (FUSED)

Occupant: _____

Depth, End of Service Pipe: ≈ 4.5'

Owner: _____

Length of Service Pipe Laid: _____

Project Contractor: A.H. GROVER

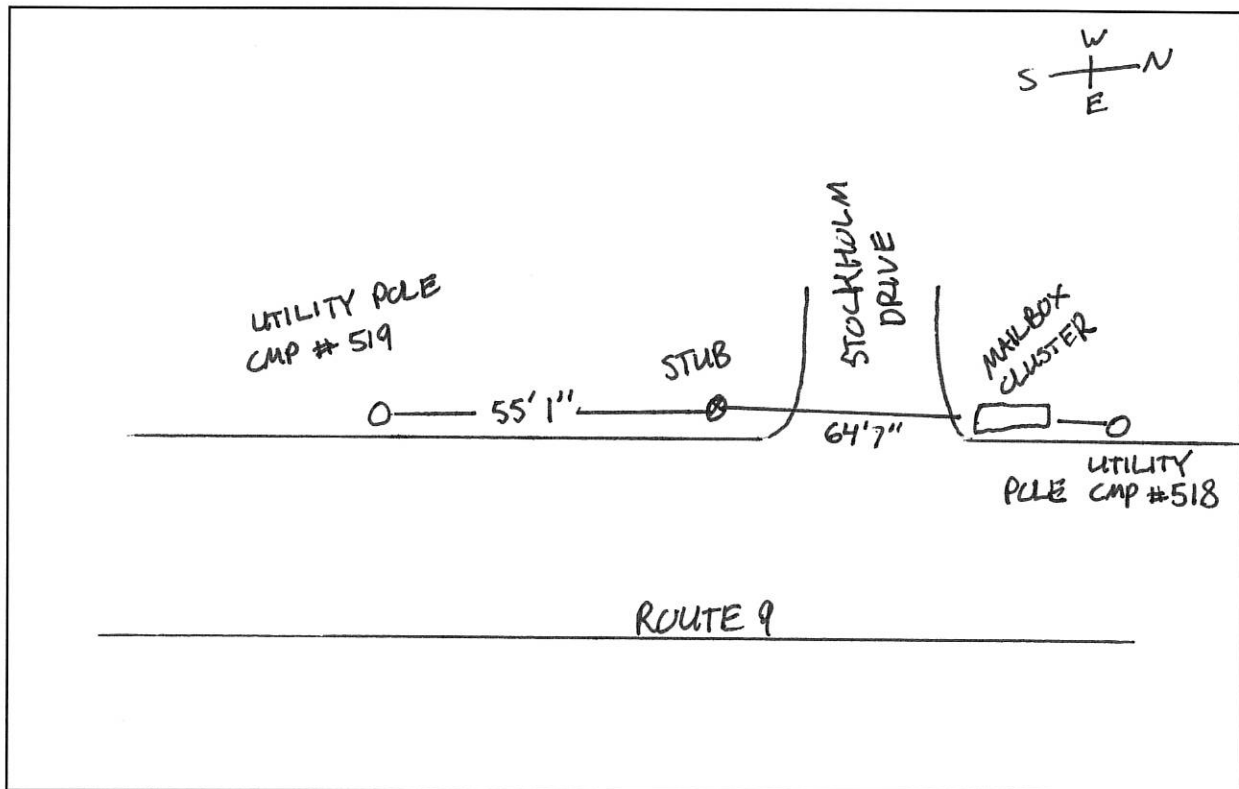

Remarks: LOW PRESSURE FORCE MAIN

SANITARY SEWER SERVICE LOCATION

Town, City of: CUMBERLAND

Date Installed: 10-10-18

Street: MAIN ST (RT.9)

Type, Size of Service Pipe: HDPE, 1.5"

Dwelling No. VACANT LOT ACROSS FROM #235

Connection at Sewer Main: 3"x1.5" TEE (FUSED)

Occupant: _____

Depth, End of Service Pipe: ≈4.5'

Owner: _____

Length of Service Pipe Laid: _____

Project Contractor: A.H. GROVER

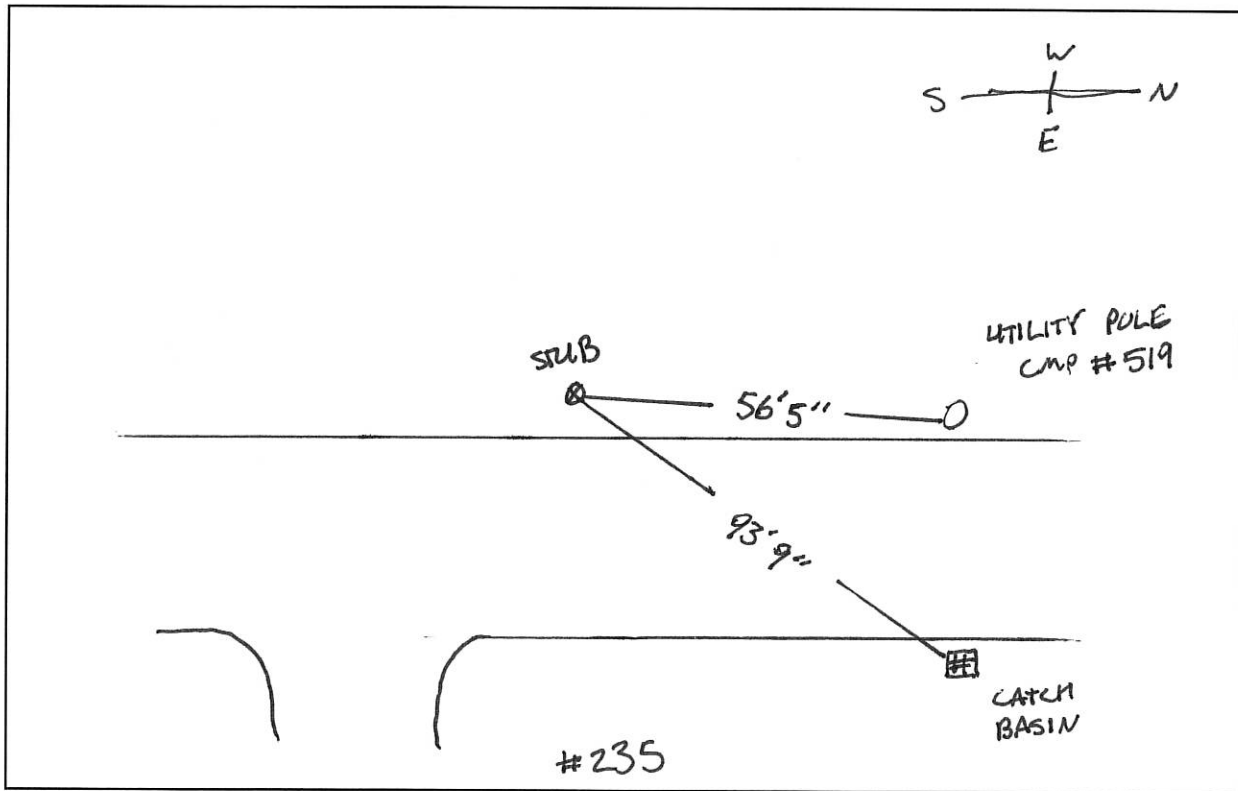

Remarks: LOW PRESSURE FORCE MAIN