

# SANITARY SEWER SERVICE LOCATION

Town, City of: CUMBERLAND

Date Installed SEPT. 21, 1983

Street ROUTE 88

Type, Size of Service Pipe 6" PVC

Dwelling No. 2 STURDIVANT RD.

Connection at Sewer Main \_\_\_\_\_

Occupant \_\_\_\_\_

Depth, End of Service Pipe 2.5' @ SLOPE = 1/8" / FOOT

Owner \_\_\_\_\_

Length of Service Pipe Laid 50'

Measured, Located By \_\_\_\_\_

Project Contractor S.E. MACMILLAN

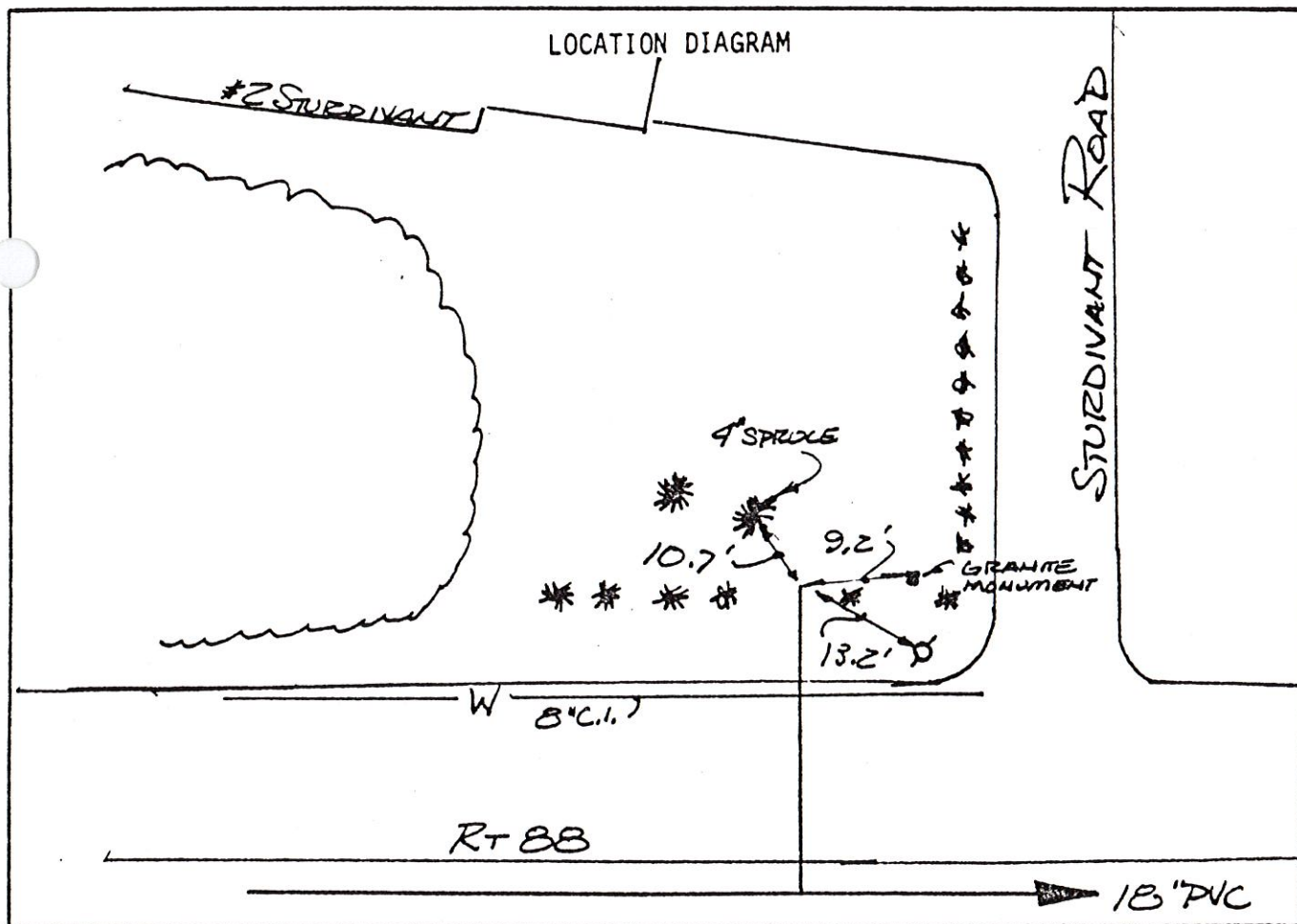

Remarks: 6" PVC GOES OVER WATER MAIN