

Town, City of: Cumberland

☐ Installed _____

Street Rt. #88

Type, Size of Service Pipe 6" PVC

Dwelling No. #1 Stonerway

Connection at Sewer Main TEE (6.5)

Occupant _____

Depth, End of Service Pipe _____

Owner _____

Length of Service Pipe Laid _____

Measured, Located By _____

Project Contractor S.E. Mac Millan

LOCATION DIAGRAM

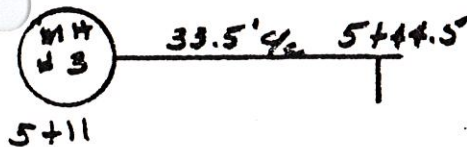

Remarks:

SANITARY SEWER SERVICE LOCATION

Town, City of: CUMBERLAND

Installed OCT. 17, 1983

Street RT 88

Type, Size of Service Pipe 6" PVC

Dwelling No. #1 STONEAWAY RD.

Connection at Sewer Main MH3+33.5'

Occupant _____

Depth, End of Service Pipe 5'

Owner Martin Anderson

Length of Service Pipe Laid 45.5'

Measured, Located By _____

Project Contractor S.E. MACMILLAN

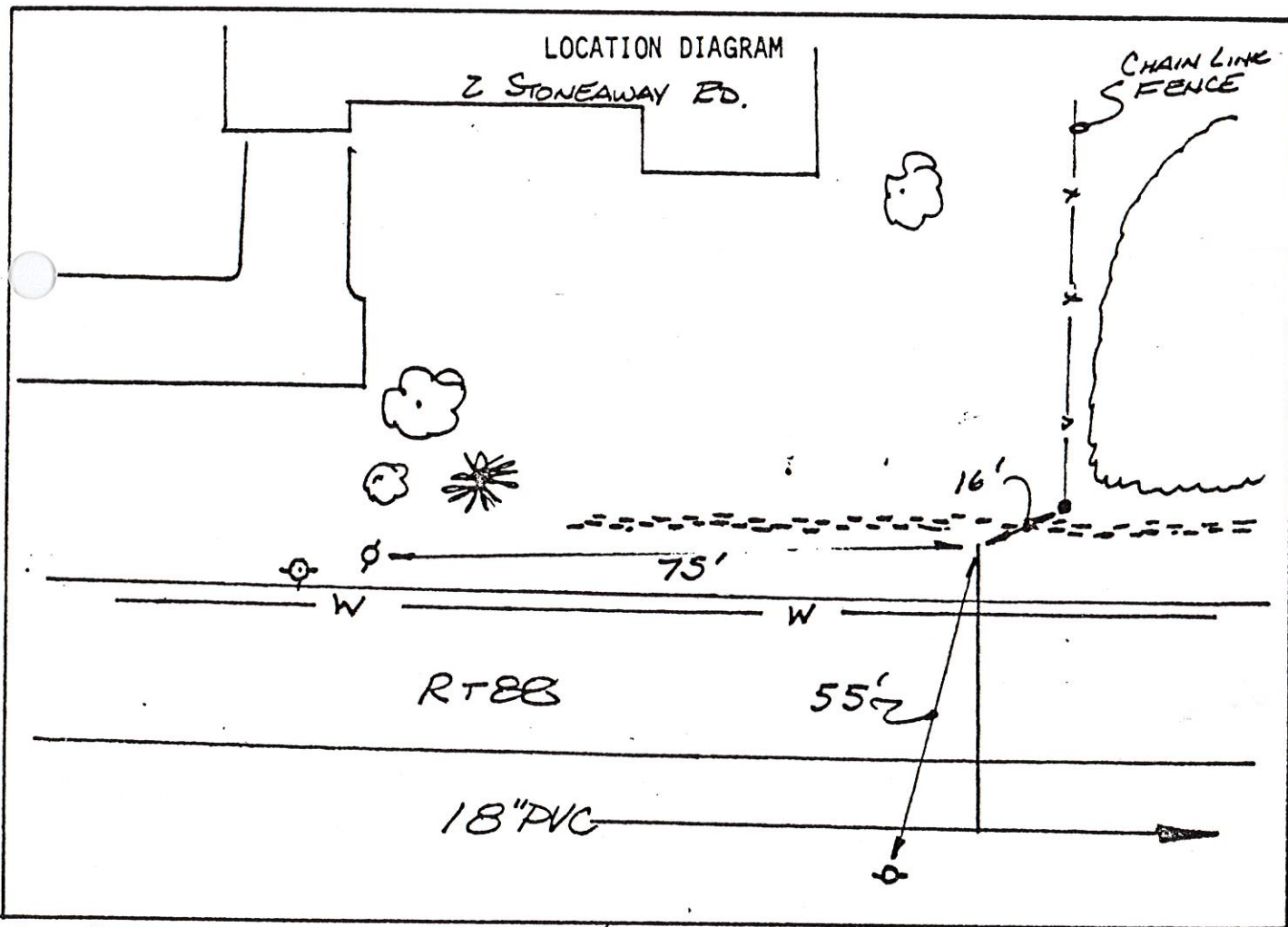

Remarks: 6" PVC GOES OVER WATER MAIN.